

› Product Guide - Motorhome, caravan, van & minivan accessories

2020





› Bring your life

Whether it's exploring spectacular nature in the great outdoors or travelling the world with family and friends, we all have a passion for enjoying an active life.

At Thule, we share your desire to spend more time enjoying our passions – which means less time worrying about how to bring all the stuff we need. In this catalogue we've collected all our recreational vehicle accessories, but that's just a small part of everything that's Thule. Thule is also a part of Thule Group, a collection of international brands that have one common mission: develop smart ways to simplify your active life.

Wherever your passion takes you, whatever you're bringing.
With Thule products, you're free to live your active life to the full.



04

Awnings

Create a shelter

Wall-mounted Awnings	12
Roof-mounted Awnings	24
Rail-mounted Awnings	28
Accessories	30



64

Bike Racks

Take along 2 or more bikes

Black Edition	68
Rear Wall-mounted Bike Racks	72
Garage-mounted Bike Racks	82
A-frame-mounted Bike Racks	86
Rear Door-mounted Bike Racks	92
Accessories	98



34

Smart Panels

Create more privacy

Sun Blocker G2	38
Rain Blocker G2	40
View Blocker G2	42
Windscreen	43
Smart Panels for vans and minivans	44



100

Storage

Perfect ways to store your belongings

Organizers	104
Fixation systems	105
Boxes	107



46

Tents

Create more outdoor living space

Tents for long stay	52
Tents for short stay	58
Accessories	62



108

Comfort & Security

Optimal safety and security during your trip

Roof rack for vans	112
Ladders	118
Steps	120
Ventilation	122
Levelers	124
Locks	125

132

Technical Specifications





› Awnings

Thule awnings are designed to provide shade on sunny days and to serve as a shelter on rainy days. We offer a wide range of awnings with unique features in order to fit any vehicle type.



A solution for every vehicle

Travelling with your recreational vehicle means freedom: you can go wherever you want, whenever you want. Make a stop at the most wonderful places and enjoy outdoor life. A Thule awning is the perfect way to have a sheltered space next to your vehicle and it also provides shade and protection against the weather elements. You can easily mount awning accessories for different purposes in just a few simple steps! Thule offers awnings in 3 different categories to perfectly fit your vehicle and personal needs.



Wall-mounted Awnings

- Most common installation on the vehicle wall
- Large range of adapters available, developed together with and approved by RV manufacturers, to fit any vehicle type
- Easy mounting in the awning rail of a caravan



Roof-mounted Awnings

- Installation on top of the RV
- Selection of adapters for specific manufacturer's models and most popular vans available
- Better integrated on the current RV design
- Alternative in case of lack of space or width restrictions



Rail-mounted Awnings

- Easy installation, no brackets needed: fits into the caravan rail
- Not permanent: you can still switch between awning and canopy
- Very light compared to the wall and roof awnings

Why choose a Thule awning?



Ease of use

Manual awnings have a telescopic hand crank for opening and motorised awnings have a remote control or a switch for effortless opening. Thanks to the Thule Quick Release system, the support legs can be released on demand to prevent them from falling during the set-up. All support legs are dropped vertically to reduce the risk of damaging your vehicle. Easily adjust the legs to the right heights with the user-friendly Thule Quick Lock system.



Superior product stability

Thule Omnistor awnings are equipped with sturdy tension arms in combination with an innovative support of the roller tube to create a perfectly tensioned awning fabric. They also increase resistance to wind for safer usage. Depending on the awning type, lengths from 4.00 m and more are supplied as standard with an integrated tensioning system or with an extra tension rafter to keep the fabric even tighter. All our awnings are tested in various weather conditions for optimal stability.



Appealing design

Thule Omnistor awnings have a timeless design that perfectly match any vehicle type. Depending on your awning type, you have the choice between following cassette finishes: anodised, white, anthracite or cream.



A leading brand in awnings for years



Wide range of accessories

Thule offers different accessories to extend your awning to suit your lifestyle. For example the Thule Smart Panels are the perfect solution if you want to create privacy and in the meantime be protected from weather elements such as sun, rain and wind. Add more outdoor living space by using a Thule awning tent.

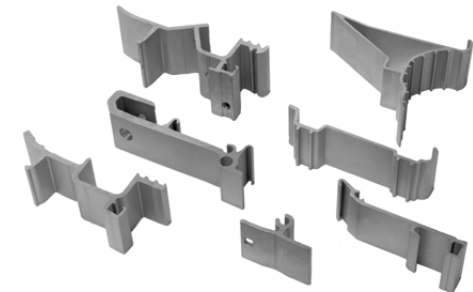

Preferred awning brand

Thule is the elected best brand in awnings for years. Thule has a large range of installation brackets and adapters available, developed together with and approved by the recreational vehicles manufacturers.

ADVICE - In case of rain, put one support leg lower so that the water can easily drain off

Awning finishes

Cassette finishes

All Thule Omnistor awnings are made of sturdy aluminium profiles that guarantee long lasting safety and reliability. Thule awnings are tested under the toughest conditions to ensure they surpass current standards.

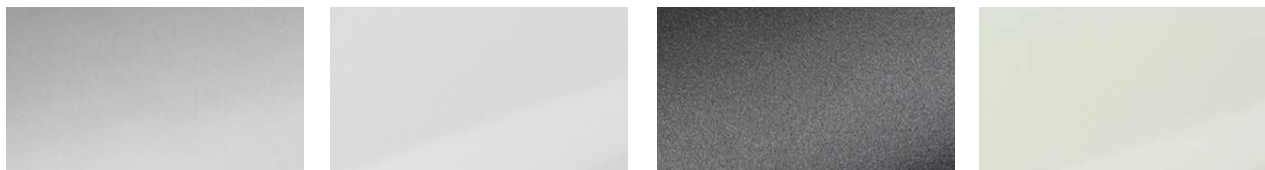

Anodised

White

Anthracite

Cream

NOTE - Cassette finishes Anthracite and Cream are only available with fabric finish Mystic Grey (31). Please refer to each awning type to find out the possible cassette and fabric finishes

Fabric finishes

The top quality PVC fabric is printed on both sides and has a coating to keep the fabric colour fixed, watertight, washable and durable. Depending on your awning type, you can choose different patterns for your awning fabric.

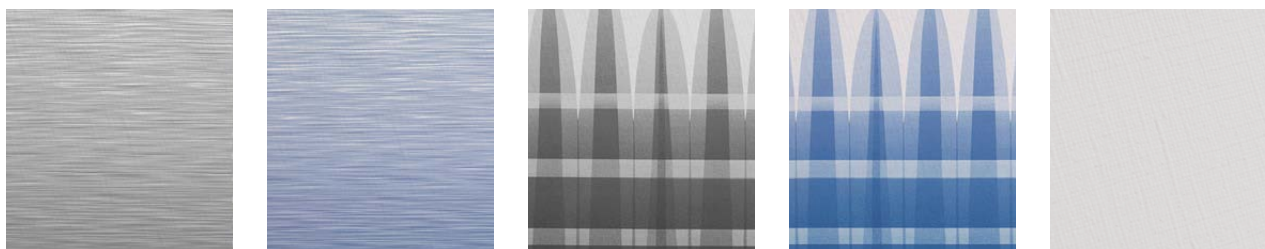

31 - Mystic Grey

32 - Sapphire Blue

04 - Alaska Grey

03 - Blue Sky

22 - Uni Grey

NOTE - Fabric finishes Alaska Grey (04), Blue Sky (03) and Uni Grey (22) are available on request with a longer delivery time

UV Protection

The coating not only ensures a high degree of scratch and fade-resistance, but also increases UV and heat-resistance.



Long lasting reliability

Top quality PVC fabric composed of 5 layers to ensure the awning is watertight, washable, durable and resistant to scratches.

- 1 - PVC top coat: ensures colour protection and scratch resistance
- 2 - Vinyl with printed pattern
- 3 - Strong layer in polyester scrim

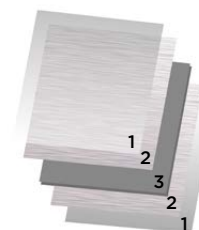



Awnings - Line at-a-glance

Wall-mounted Awnings



Thule Omnistor 5200



Anodised White Anthracite



Thule Omnistor 8000



Anodised White Cream
Anthracite



Thule Omnistor 4900



Anodised White Anthracite



Thule Omnistor 5102



Light Grey Anthracite



Thule 3200



Anthracite Anodised/Anthracite

Roof-mounted Awnings



Thule Omnistor 6300



Anodised White Anthracite



Thule Omnistor 9200



Anodised White Cream

Rail-mounted Awnings



Thule Omnistor 1200



White

Wall-mounted Awnings Thule Omnistor 5200

The new standard for RV awnings

Thule Omnistor 5200 awning perfectly fits any vehicle type. Its design and look match the contemporary recreational vehicle designs and is better integrated on the vehicle sides. The awning is up to 3% lighter than its predecessor and is available in 8 lengths from 1.92 m to 5.02 m with a maximum projection of 2.50 m.

Operated manually or with a motor

An optional 12 VDC motor with manual override allows you to operate awning lengths from 3.00 m and more without any effort. The motor can easily be installed retrofit as an accessory on a manual Thule Omnistor 5200 awning (+ 1 kg).

Perfect fabric tension

Sturdy spring arms with patented integrated tension arms ensure a perfectly tensioned awning fabric for increased wind resistance. The patented tension arms are standard integrated for awning lengths from 4.02 m and more and are optional for a 3.02 m or 3.52 m awning length.



Add to your Thule Omnistor 5200

Smart Panels - See p.34

Tents - See p.46

See more accessories
p.30 to 33



Thule Omnistor 5200 - Manual



Thule Omnistor 5200 - Motorised



Wall-mounted Awnings Thule Omnistor 5200



CASSETTE FINISHES

-  Anodised
-  White
-  Anthracite



User
instruction



Wall-mounted Awnings Thule Omnistor 5200



Thule Motor Kit TO 5200 - An optional 12 VDC motor with manual override mechanism allows you to operate awning lengths from 3.00 m and more without any effort. Control is made with a switch through one touch command. The motor can easily be installed retrofit on a manual Thule Omnistor 5200 awning. Only 1 kg additional weight and 3 cm additional length compared to a manual awning.



Thule Pitch System - The incline of the awning fabric can be set as you please to easily open the door of your vehicle without touching the awning fabric.

Optimal closing - An easy roller tube adjustment system on the side opposite to the gear assures a perfect closing of the cassette, even after years of usage.





Wall-mounted Awnings Thule Omnistor 8000

Largest wall awning on the market

Thule Omnistor 8000 awnings are available in 5 lengths from 4.00 m to 6.00 m with a projection of 2.75 m. The awning cassette is available in anodised, white, cream and anthracite.

Operated manually or with a motor

The optional 230 VAC motor with remote control allows you to operate the awning without any effort. Settings are programmed digitally to ensure a perfect closing of the front profile. A safety device has been created to operate the awning in case of electricity failure. The motor can easily be installed retrofit as an accessory on a manual Thule Omnistor 8000 awning (+2 kg).

Perfect fabric tension

Thanks to Thule's unique integrated tension rafter in the spring arm, the fabric is always well tensioned. The spring arm, reinforced with a double steel cable, automatically deploys the tension rafter to ensure the awning stays stable and resistant to wind.



Add to your Thule Omnistor 8000

Smart Panels - See p.34

Tents - See p.46

See more accessories
p.30 to 33



Thule Omnistor 8000 - Manual



Thule Omnistor 8000 - Motorised



Wall-mounted Awnings Thule Omnistor 8000



Optional 230 VAC motor -

A remote control allows you to operate the awning without any effort.

Easy cleaning -

Equipped with its own drainage system in the front profile. This is convenient in case of rain but also when cleaning the fabric once or twice a year with the Thule PVC Cleaner.

Thule Quick Lock System -

User-friendly system to help you set up and adjust the support legs to the right heights.

Perfect fabric tension -

Thanks to Thule's unique integrated tension rafter in the spring arm, the fabric is always well tensioned.

CASSETTE FINISHES

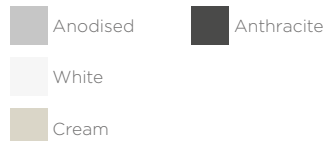

User instruction
Motorised



Wall-mounted Awnings Thule Omnistor 4900



The lightweight awning

The Thule Omnistor 4900 awning is available in 5 lengths from 2.60 m to 4.50 m with a maximum projection of 2.50 m. The awning cassette is available in anodised, white and anthracite.

Lightness and stability

The awning is equipped with a small roller tube support which results in a huge weight reduction, while being stable and having an optimal fabric tension. Awning lengths 4.00 m and 4.50 m have a tension rafter supplied as standard.

Smart innovations

The oval support legs are dropped vertically to reduce the risk of damaging the vehicle wall.

Optimal closing

An easy roller tube adjustment system on the side opposite to the gear assures a perfect closing of the cassette, even after years of usage.



Add to your Thule Omnistor 4900

Smart Panels - See p.34

Tents - See p.46

See more accessories
p.30 to 33



Thule Omnistor 4900 - Manual



CASSETTE FINISHES

- Anodised
- White
- Anthracite



Awning packs for vans and minivans

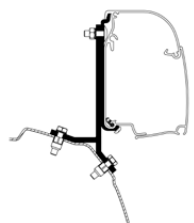

Thule Omnistor 4900 + Ford Transit/Tourneo Custom Adapter

Complete set with Thule Omnistor 4900 awning and adapters to fit Ford Transit/Tourneo Custom vans.

FEATURES

- Suitable for Ford Transit and Ford Tourneo Custom vans
- The set is available with a Thule Omnistor 4900 awning with length 2.60 m (fabric finish: 31 - Mystic grey)
- For vehicles with a lift roof
- Quick and easy installation by blind assembly (requires no access from the inside)
- The awning is not removable

■ 301776 - 2.60 x 2.00 m (LHD)
Anthracite

■ 301777 - 2.60 x 2.00 m (RHD)
Anthracite

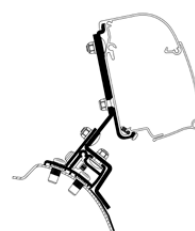
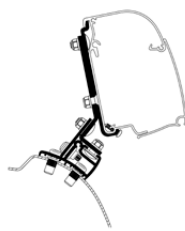

Thule Omnistor 4900 + PSA Minivan Adapter

Complete set with Thule Omnistor 4900 awning and adapters to fit PSA minivans from 2016.

FEATURES

- Suitable for Citroën Spacetourer, Peugeot Traveller and Toyota Proace
- The set is available with a Thule Omnistor 4900 awning with length 2.60 m (fabric finish: 31 - Mystic grey)
- The maximum height is less than 2 meters
- For vehicles with a lift roof
- Quick and easy installation by blind assembly (requires no access from the inside)
- The awning is still removable
- The adapter must be mounted on the roof according to the prescribed instructions, the mounting requires no rail
- Perfect finish and integration with the vehicle thanks to the black plastic adapter covers

■ 301769 - 2.60 x 2.00 m (LHD)
Anthracite

■ 301770 - 2.60 x 2.00 m (RHD)
Anthracite

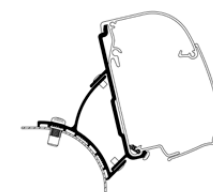

Thule Omnistor 4900 + Volkswagen T5/T6 Adapter

Complete set with Thule Omnistor 4900 awning and adapters to fit Volkswagen T5/T6 vans.

FEATURES

- Suitable for Volkswagen T5/T6 models without any rail
- The set is available with a Thule Omnistor 4900 awning with length 2.60 m or 3.00 m (fabric finish: 31 - Mystic grey)
- For vehicles with a lift roof
- Quick and easy installation by blind assembly (requires no access from the inside)
- The awning is not removable
- The adapter must be mounted on the roof according to the prescribed instructions, the mounting requires no rail

■ 301772 - 2.60 x 2.00 m (LHD)
Anthracite

■ 301773 - 3.00 x 2.50 m (LHD)
Anthracite

■ 301774 - 2.60 x 2.00 m (RHD)
Anthracite

■ 301775 - 3.00 x 2.50 m (RHD)
Anthracite

Wall-mounted Awnings Thule Omnistor 5102

Small awning conceived for Volkswagen T5/T6

The Thule Omnistor 5102 awning is developed together with and approved by Volkswagen. Comes in a standard length of 2.60 m with a projection of 2.00 m and is available in the colours light grey and anthracite.

Easy installation

Its easy installation makes it the perfect fit for city living. Mounted to the existing roof rails using the supplied adapter.

Living space

Increase your living space with 5 m² by adding a Thule Residence G3 awning tent, especially created for the Thule Omnistor 5102 awning.

Colour harmony

Two cassette colours are available in order to increase the harmony of your Volkswagen. Anthracite matches the bumper and door handles of your minivan.



Add to your Thule Omnistor 5102

Smart Panels - See p.34

Tents - See p.46

See more accessories
p.30 to 33



Thule Omnistor 5102 - Manual



Wall-mounted Awnings Thule Omnistor 5102



Thule Quick Lock System - User-friendly system to help you set up and adjust the support legs to the right heights.

NOTE - The supplied adapter is only suitable for VW Multivan.
For VW California ask your Volkswagen dealer for more information

CASSETTE FINISHES

 Light Grey

 Anthracite



Wall-mounted Awnings Thule 3200

Manual roll-up box awning for compact vehicles

The Thule 3200 awning is available in 5 lengths from 1.90 m to 3.00 m with a projection of 2.50 m. The awning cassette is available in completely anthracite finish or anodised with anthracite bottom and black end caps.

Mounting

Ideal for direct mount on selected range of minivans and roof rack installation on cars. The awning brackets need to be bought separately.

One-person operation

The awning can be set up by only one person. Open the cassette and take out the tension arms. Roll out the awning manually and set up the support legs. At last, connect the tension arms with the support legs and create tension.

Large projection

All awning lengths have a projection of 2.50 m, the largest projection on the market within its category.



Add to your Thule 3200

Smart Panels - See p.34

See more accessories
p.30 to 33



Thule 3200 - Manual



Wall-mounted Awnings Thule 3200



New

Awnings

One person operation -
Open the cassette and unroll
the awning manually.



Perfect stability -
Well designed end parts
give the awning a high
quality standard and a
perfect wind resistant.

Mounting - Thanks
to sturdy profiles the
awning can be mounted
directly on the vehicle
with brackets or
onto a roof rack.

**Exclusive fabric tensioning
system -** with pump-buckle
technology.

Design - Contemporary look
which perfectly integrates with
any vehicle design.

Projection - Largest awning
projection of 2.50 m on the
market within its category,
for all lengths.

Thule Quick Lock System -
User-friendly system to help you
set up and adjust the support
legs to the right heights.

Accessories - Large range of
accessories available: smart
panels, strap kit, etc.

CASSETTE FINISHES

 Anthracite

 Anodised/Anthracite



Roof-mounted Awnings

Thule Omnistor 6300

Universal roof awning in a contemporary design

The Thule Omnistor 6300 roof awning is available in 9 lengths from 2.60 m to 5.00 m with a maximum projection of 2.50 m. The awning cassette is available in anodised, white and anthracite.

Operated manually or with a motor

An optional 12 VDC motor with manual override allows you to operate awning lengths from 3.00 m and more without any effort. The motor can easily be installed retrofit as an accessory on a manual Thule Omnistor 6300 awning (+ 1 kg).

Perfect fabric tension

Sturdy spring arms with patented integrated tension arms ensure a perfectly tensioned awning fabric for increased wind resistance. The patented tension arms are standard integrated for awning lengths from 3.75 m and more and are optional for the smaller awning lengths.



Add to your Thule Omnistor 6300

Smart Panels - See p.34

Tents - See p.46

See more accessories
p.30 to 33



Thule Omnistor 6300 - Manual

Thule Omnistor 6300 - Motorised



Roof-mounted Awnings

Thule Omnistor 6300



CASSETTE FINISHES



User
instruction
Manual



User
instruction
Motorised



Roof-mounted Awnings Thule Omnistor 9200

The perfect roof awning for extra large vehicles with a projection of 3 meters

The Thule Omnistor 9200 awning has been designed to perfectly integrate with any vehicle design. The awning is available in 5 lengths from 4.00 m to 6.00 m and is especially convenient for large vehicles. The awning is equipped with an anti-rattling device to enjoy a smoother ride.

Operated manually or with a motor

The optional 230 VAC motor with remote control allows you to operate the awning without any effort. Settings are programmed digitally to ensure a perfect closing of the front profile. A safety device has been created to operate the awning in case of electricity failure. The motor can easily be installed retrofit as an accessory on a manual Thule Omnistor 9200 awning (+2 kg).

Perfect fabric tension

Thanks to Thule's unique integrated tension rafter in the spring arm, the fabric is always well tensioned. The spring arm, reinforced with a double steel cable, automatically deploys the tension rafter to ensure the awning stays stable and resistant to wind.



Add to your Thule Omnistor 9200

Smart Panels - See p.34

Tents - See p.46

See more accessories
p.30 to 33



Thule Omnistor 9200 - Manual

Thule Omnistor 9200 - Motorised



Roof-mounted Awnings Thule Omnistor 9200



Design - Perfectly integrated with any vehicle design. Improved masking and finish of the technical parts.

Easy and safe - The optional 230 VAC motor with remote control allows you to operate the awning without any effort. Settings are programmed digitally to ensure a perfect closing of the front profile.



Perfect fabric tension -

Sturdy spring arms ensure the awning fabric is perfectly tensioned. They also increase resistance to wind for safer usage. The spring arm, reinforced with a double steel cable, automatically deploys the tension rafter to ensure the awning stays stable and resistant to wind.

Thule Quick Lock System -

User-friendly system to help you set up and adjust the support legs to the right heights.

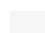
CASSETTE FINISHES

-  Anodised
-  White
-  Cream



User instruction
Motorised

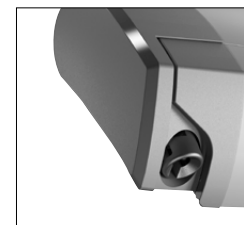

Rail-mounted Awnings

Thule Omnistor 1200

Stability and large projection for a bag awning

The Thule Omnistor 1200 bag awning is available in 11 lengths from 2.30 m to 5.50 m with a maximum projection of 2.50 m.

Easy and fast set-up of the awning

The awning is stored in a PVC-sleeve with a sewn rope which simply slides into the caravan rail. Open the sleeve and unroll the awning. The simultaneous swing-out of the support legs and tension arms enables an easy and fast set-up.

Exclusive fabric tensioning system

With pump-buckle technology. Extremely user-friendly: click back and forwards to ensure the awning fabric is perfectly tensioned.

TO 1200 in combination with a Thule awning tent

The Thule Omnistor 1200 fits the Thule QuickFit tent by using an optional kit. The Thule Awning Fixation Kit TO 1200 consists of several profiles to slide into the integrated kador attached at the inner side of the awning bag.



Add to your Thule Omnistor 1200

Smart Panels - See p.34

Tents - See p.46

See more accessories
p.30 to 33



Thule Omnistor 1200



Rail-mounted Awnings

Thule Omnistor 1200



Support kit -

A clever integrated tension leg support kit spreads the load safely on the caravan wall. This all fits into a small white bag.

Exclusive fabric tensioning system -

With pump-buckle technology.

Perfect stability -

Awning lengths from 3.50 m and more have an integrated fixation for an optional 3rd support leg which ensures a higher stability. Awning lengths from 4.00 m and more have a tension rafter supplied as standard.

Easy and fast set-up -

The awning is stored in a PVC-sleeve with a sewn rope which simply slides into the caravan rail. Open the sleeve and unroll the awning.

Thule Quick Lock System -

User-friendly system to help you set up and adjust the support legs to the right heights.

BAG FINISH

White



User instruction



Awnings - Accessories

Lighting



Thule Tent LED Mounting Rail TO 6300

This profile can be slid at the bottom of the Thule Omnistor 6300 | 6200 | 9200 roof awning cassette. Provided with a channel to slide a Thule tent or the Thule organizers in and has additional space for a Thule LED Strip. The LED Light can be used both when the awning is opened or closed.

- Length: 4.00 m

301664
Anthracite

NOTE - Only compatible with Thule LED Strip Sideways

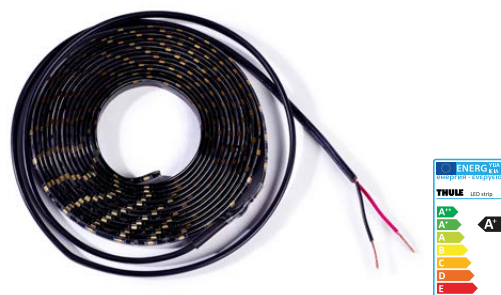

Thule LED Strip Sideways

Long lasting and waterproof (IP65) LED strip to offer strong natural sideways light (60 power LEDs per meter). The flexible unit can be shortened each 5 cm and is delivered with a 3M tape on the back to stick to most standard surfaces.

- Voltage: 12 VDC
- Consumption: 340-380 mA per metre
- Length: 4.00 m

301660
Anthracite



Thule Tent LED Mounting Rail TO 5200

This aluminium profile covers the adapters and is provided with a channel to slide a Thule tent or the Thule Organizers in and has additional space for a Thule LED Strip. The LED light can be used both when the awning is opened or closed.

- Available in different lengths
- Colours: anthracite, anodised and white



Thule LED Strip

Long lasting and waterproof (IP65) LED strip to offer strong warm white light (60 power LEDs per meter). The flexible unit can be shortened each 5 cm and is delivered with a 3M tape on the back to stick to most standard surfaces.

- Voltage: 12 VDC
- Consumption: 340-380 mA per metre
- 307135 - 4.00 m / 307136 - 5.00 m / 307137 - 6.00 m

White



Thule LED Mounting Rail TO 6300/6200/9200

306777 - Profile to fit the opening in the bottom of the Thule Omnistor 6300 | 6200 | 9200 roof awning cassette for the installation of a Thule LED Strip. The minimum required distance between the roof and the underside of the awning must be 12 mm.



Awnings - Accessories

Awnings motorisation



Thule Motor Kit TO 5200

Retrofit motor kit (12 VDC) for Thule Omnistor 5200 awning lengths from 3.00 m and more. Includes a switch with one touch command.

- Weight: 1 kg

301296 White	301297 Anodised	301298 Anthracite
-----------------	--------------------	----------------------



Thule Motor Kit TO 8000/9200

Retrofit motor kit (230 VAC) for awnings Thule Omnistor 8000 | 9200. Includes a remote control and relay.

Thule Omnistor 8000

302530 White
302531 Anodised
302532 Cream

Thule Omnistor 9200

302533 White
302534 Anodised
302535 Cream



Thule Motor Kit TO 6300

Retrofit motor kit (12 VDC) for Thule Omnistor 6300 awning lengths from 3.00 m and more. Includes a switch with one touch command.

- Weight: 1 kg

302096 White	302097 Anodised	302098 Anthracite
-----------------	--------------------	----------------------

Sealings

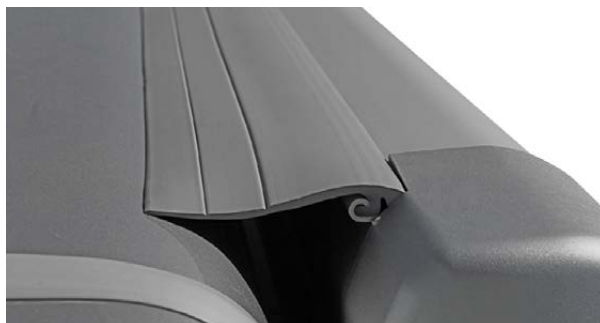

Thule Sealing Rubber

Ensures that the gap between the vehicle and wall awning is sealed when using a flat adapter. Fitted with an integrated drainage system.

- Length: 4.00 m
- 307960 - For series Thule Omnistor 5 & 8 - small 5 cm
- 307961 - For series Thule Omnistor 5 & 8 - large 8 cm
- 306892 - For Thule Omnistor 4900 - medium 6 cm



Thule EPDM

308697 - Black EPDM foam strip with closed cell structure to seal the gap between the vehicle and a roof-mounted awning.

- Length: 2 x 2.00 m
- Thickness: 25 mm
- Width: 30 mm



Thule Gutter

This self-adhesive drainage system fits most caravans and motorhomes.

- 307947 - Length: 3.50 m
- 307967 - Length: 4.50 m

Awnings - Accessories

Wind protection



New



Thule Fabric Clamps

309698 - These clamps provide a more secure fastening between the awning fabric and the tension rafter or blocker rafter to prevent the unpleasant noise of a flapping awning fabric due to wind. The clamps have an universal fitting on most rafter profiles, just click it on the rafter, put the fabric in between and tighten with the handle.

FITS

- Oval side blocker rafter
- Thule Tension Rafter G2
- Square telescopic tension rafter TO 1200

NOTE - A set contains 2 clamps.
You can use up to 2 clamps on one side of the awning



Thule Tension Rafter G2

An additional rafter ensures an optimal tensioned awning fabric for a better wind resistance. The rafter is made from durable anodised aluminium profiles in combination with high impact plastics. No heavy manpower is needed for the installation.

*Fits only at the side of the awning, not at the middle

Easy installation in only 3 steps

- 1 - Open your awning.
- 2 - Place the rafter into the awning. This is effortless thanks to the smooth integrated spring.
- 3 - Slightly roll-up the awning fabric until the rafter is blocked. Perfect tension is reached when the two black parts touch each other.

	Projection	Awning type	Ref.
Thule Tension Rafter G2 Wall	2.00 m*	TO 5200 4900 5003 5002	307307
Thule Tension Rafter G2 Roof		TO 6300 6200 6002	307308
Thule Tension Rafter G2 Wall	2.50 m	TO 5200 4900 5003 5002	307309
Thule Tension Rafter G2 Roof		TO 6300 6200 6002	307310
Thule Tension Rafter G2 TO 1200		TO 1200	307311
Thule Tension Rafter G2 Wall/Roof	2.75 m	TO 8000 6900	307312
Thule Tension Rafter G2 Roof	3.00 m	TO 9200	307313

Awnings - Accessories

Wind protection



Thule Hold Down Side Strap Kit

307916 - This kit prevents the awning and tent from being damaged due to high wind. The two straps are attached to the support legs and can easily be used with a Thule tent or the Thule Smart Panels.



Thule Hold Down Kit

307906 - This kit strengthens your awning to prevent it from flying away. It is installed over the awning length between the spring arms and the fabric.



Thule Tension Arm Set TO 5200

301295 - Optional tension arm set to increase the wind resistance for Thule Omnistor 5200 awning lengths 3.02 m and 3.52 m. Included for the longer awning lengths. See p.12



Thule 3rd Support Leg

306778 - To reinforce the longer lengths of awning tents in combination with a rafter. Cannot be used in combination with the Thule QuickFit tent. Can be installed on all awning types from 3.75 m on, except TO 4900 and TO Caravan Style.



Thule Tension Arm Set TO 6300

302095 - Optional tension arm set to increase the wind resistance for Thule Omnistor 6300 awning lengths 3.00 m, 3.25 m and 3.50 m (not suitable for awning length 2.60 m). Included for the longer awning lengths. See p.24

Maintenance



Thule Repair Patch

306486 - To repair small rips in your awning's fabric. Consists of 3 self-adhesive transparent patches of 7.5 x 15 cm.



Thule PVC Cleaner

307585 - Ideal for cleaning the awning and tent fabric twice a year. Supplied in a user-friendly spray bottle.





› Smart Panels

Create additional privacy under your awning by easily attaching one or more smart panels to your awning. Moreover these panels protect you against sun, rain and wind and can be combined in many ways for an optimal protection.



Smart Panels - Line at-a-glance



Thule Sun Blocker G2 - Front



Thule Sun Blocker G2 - Side



Thule Rain Blocker G2 - Front



Thule Rain Blocker G2 - Side



New

**Thule Rain Blocker G2
Pack Minivan**



Thule View Blocker G2 - Side



Thule Windscreen



Awning fixation Thule Sun Blocker G2

Protection against the sun

Front and side privacy panels for Thule Omnistor awnings to let the breeze in while keeping the sun out, without losing your view. Available in different sizes depending on your awning length, projection and mounting height.

Fabric material

Made of micro-aired screen fabric, a transparent and light screen fabric.

Installation

The front panel is suitable for all Thule Omnistor awnings and easily slides into the awning lead rail. The side panel slides into an aluminium rafter installed between the awning's cassette and lead rail. The side panel can be installed on both sides of the awning with the same rafter.

Combination with an awning tent

Combine easily the Thule Sun Blocker G2 side panel with a Thule QuickFit awning tent for more comfort. The Thule Sun Blocker G2 front panel can be used in combination with the Thule Residence G3 awning tent with the optional profiles. See p.56 to 61



Add to your Thule Sun Blocker Side



Thule Fabric Clamps

These clamps provide a more secure fastening between the awning fabric and the blocker rafter to prevent the unpleasant noise of a flapping awning fabric due to wind. See p.32



Storage

Thule Luxury Blocker Bag

301568 - Luxurious black bag to store your tension rafter, panel and fixation material - LxWxH: 130 x 20 x 20 cm.



Awning fixation Thule Sun Blocker G2



FIT GUIDE - See p.136 to 138

Modular system

Combine easily the Thule Sun Blocker G2 panels with other Smart Panels. The front panels can be rolled up when they are not in use.



User
instruction



Awning fixation Thule Rain Blocker G2

Protection against rain and wind

Front and side privacy panels for Thule Omnistor awnings to protect against rain and wind. Each panel has a large transparent window keeping the light coming in to create a spacious feeling. Available in different sizes depending on your awning length, projection and mounting height.

Fabric material

Made of high quality transparent PVC fabric.

Installation

The front panel is suitable for all Thule Omnistor awnings and easily slides into the awning lead rail. The side panel slides into an aluminium rafter installed between the awning's cassette and lead rail. The side panel can be installed on both sides of the awning with the same rafter.

Combination with an awning tent

Combine easily the Thule Rain Blocker G2 side panel with a Thule QuickFit awning tent for more comfort. See p.60



Add to your Thule Rain Blocker Side



Thule Fabric Clamps

These clamps provide a more secure fastening between the awning fabric and the blocker rafter to prevent the unpleasant noise of a flapping awning fabric due to wind. See p.32

New

Storage

Thule Luxury Blocker Bag

301568 - Luxurious black bag to store your tension rafter, panel and fixation material - LxWxH: 130 x 20 x 20 cm.



Awning fixation Thule Rain Blocker G2



Installation front panel - The front panel slides into the awning lead rail. The panels can be connected to each other and to the side panel thanks to the smart connections.

Installation side panel - The side panel slides into an aluminium rafter with channel, installed between the awning's cassette and lead rail. The panel is attached to the awning support leg with smart connections.

Fabric material - Made of high quality transparent PVC fabric.

Strong ground fixation - Pegs, ropes and smart connections included.



Windslip

Practical - The front panels can be rolled up and are fixed with a side release buckle.

Thule Rain Blocker G2 Pack Minivan New

Set of 2 side panels and 2 front panels for Thule Omnistor 5102 | 4900 awning lengths 2.60 m mounted on minivans.

SET INCLUDES

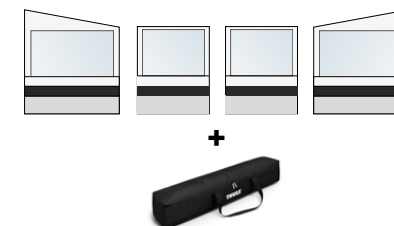

FITS MINIVANS

- Volkswagen T5/T6 (California, etc.)
- Ford Custom
- Ford Custom Nugget
- Peugeot Traveller, Citroën Spacetourer (Campster), Toyota Proace
- Renault Traffic
- Mercedes Benz V-Klasse Marco Polo
- PSA Minivan > 2016

FIT GUIDE - See p.136 to 138

Modular system

Combine easily the Thule Rain Blocker G2 panels with other Smart Panels. The front panels can be rolled up when they are not in use.



User instruction



Awning fixation Thule View Blocker G2

Protection against rain, wind and sun

Side privacy panel for Thule Omnistor awnings to create complete privacy while being protected from rain, wind and sun. The side panel is available in two sizes depending on the mounting height of the awning between 2.25 m and 2.64 m.

Fabric material

Made of high quality non-transparent PVC fabric.

Installation

The side panel slides into an aluminium rafter with channel installed between the awning's cassette and lead rail. It's attached to the awning support leg with smart connections. The side panel can be installed on both sides of the awning with the same rafter.

FIT GUIDE - See p.136 to 138



Add to your Thule View Blocker Side



Thule Fabric Clamps

These clamps provide a more secure fastening between the awning fabric and the blocker rafter to prevent the unpleasant noise of a flapping awning fabric due to wind. See p.32



Storage

Thule Luxury Blocker Bag

301568 - Luxurious black bag to store your tension rafter, panel and fixation material - LxWxH: 130 x 20 x 20 cm.



Wall fixation Thule Windscreen

Protection against wind

Easy to install side panel which lets the light and breeze in while keeping the elements out ensuring privacy.

Fabric material

Made of micro-aired screen fabric, a transparent and light screen fabric.

Installation

Easy and quick to set up thanks to its automatic roll in and out system. It can be fixed to the vehicle via wall fixation or slide it into the caravan rail. Unroll it and connect it to the awning support leg or make it free standing with the delivered strap kit.



Storage

The Thule Windscreen is delivered with a bag for easy storage.

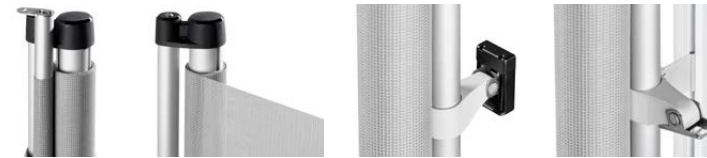

User
instruction



Awning fixation Thule Smart Panels for vans

FIT GUIDE - See p.136 to 138 



Awning fixation Thule Smart Panels for minivans

FIT GUIDE - See p.136 to 138 







› Tents

A tent gives you the perfect outdoor living space. The highly versatile range of Thule awning tents offers an option to suit every desire.

Why choose a Thule Tent?

Easy installation

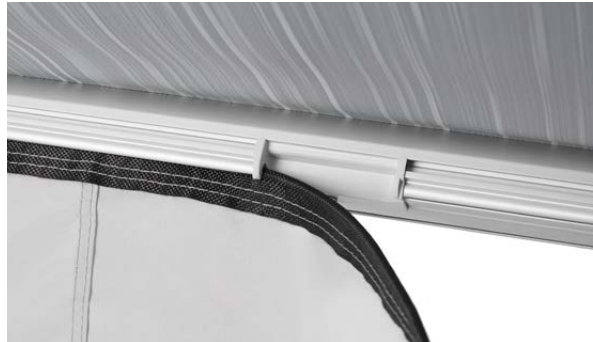

Long stay: Thule Veduta, Thule Panorama or Thule Residence G3

For easy installation, your awning transforms to become your roof, making it quicker to set up your tent. The tent consists of 3 panels: 2 sides and 1 front, all which connect to the awning. The side panels also connect to your vehicle for a perfect sealing. The front panel slides into the awning lead rail, creating a water-resistant room.

Stability and security



Depending on the awning tent type, Thule uses different durable high quality fabric materials: Airtex, PVC or Ripstop that provide wind and water tightness. Moreover all Thule awning tents are tested in various weather conditions to guarantee optimal stability and security.

Innovative design



Short stay: Thule QuickFit

This tent exists of 1 piece and takes only 15 minutes to set up. Slide it in the caravan rail or in an additional rail below your awning cassette and fix it to the awning lead rail. In this way you create a double roof which offers a good insulation to keep the tent and vehicle cool. Side windows are provided with mosquito mesh.

Thule awning tents have a contemporary design in line with the awning design. Thanks to the combination of neutral colours: black, white, grey and silver, they suit all awning fabric colours. Large windows invite maximum light and create an extra feeling of spaciousness. Permanent ventilation openings reduce condensation.

Modularity

Thanks to the clever design, the awning tents can be installed completely but most of the panels are unzippable and removable to create door openings on different sides.

Thule Veduta

- The front panel is easy to install as one complete piece with two or three window panels
- The 4 window panels are unzippable
- One panel has two integrated door openings and can be placed anywhere you want



Thule Panorama

- You can fully remove the large front and side windows or open them vertically to use as a door, or horizontally to let the fresh air in



Thule Residence G3

- The window panels can be rolled upwards
- Front panels starting from 3.50 m length have a door opening on both sides and can also be rolled up separately for easy entrance
- It is possible to add accessories in the optional rail at the front panel



Thule QuickFit

- All sides are fully zippable
- They can be taken away to create an open porch, can be opened sideways to create a door on all sides, left or right and can be opened from top to bottom to create an open window





Tents - Line at-a-glance

Long stay



Thule Veduta



Thule Panorama



Ducato H2



Thule Residence G3



Short stay



**Thule Residence G3
for Eriba Touring**



**Thule Residence G3
for VW T5/T6**



Thule QuickFit



Ducato H2

Tents

Thule Veduta

Awning tent especially designed for caravans

The Thule Veduta awning tent is available in four lengths and can only be used in combination with a Thule Omnistor 6300 | 6200 roof awning mounted on a caravan.

Installation

The awning tent is delivered with claming profiles to mount the side panels and connect them with the awning fabric for a perfect roof sealing. The side panels slide into the claming profiles and the front panel slides into the awning lead rail. Both panels are combined with a zipper for optimal closing. The sloping front panel offers a large internal living surface and creates an extra feeling of spaciousness.

Fabric material

AIRTEX® is perfect for solar protection applications. This light fabric is 100% polyester fabric, which is coated with acrylate on one side and impregnated. The special coating gives AIRTEX® a distinctively textile character.



Add to your Thule Veduta



Thule Curtains

301565 - Easily create more privacy by adding curtains.

See more accessories p.62 to 63

Modularity - Completely adaptable to all your needs - See p.49



Tents

Thule Veduta



New



INCLUDED

- Windslip and wheelcover: prevent the wind from entering through the gap below your vehicle
- 2 luxury storage bags

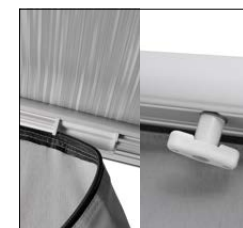

Tents

Thule Panorama

Awning tent with a high living comfort and stunning view

The Thule Panorama awning tent is available in different sizes depending on your Thule Omnistor awning type, projection and mounting height. Special model available for a Ducato H2 van in combination with the Thule Omnistor 6300 roof awning.

Installation

The tent is delivered with clamping profiles to mount the side panels and connect them with the awning fabric for a perfect roof sealing. The side panels slide into the clamping profiles and the front panel slides into the awning lead rail. Both panels are combined with a zipper for optimal closing.

Fabric material

AIRTEX® is perfect for solar protection applications. This 200g/m² light fabric is a 100% polyester fabric, which is coated with acrylate on one side and impregnated. The special coating gives AIRTEX® a distinctively textile character.



Add to your Thule Panorama



Thule Mosquito

Zippable panel to replace the standard front or side of the Thule Panorama tent. Made of mosquito mesh to create additional ventilation.



Thule Curtains

Easily create more privacy by adding curtains. Different sizes available in the colour grey.

See more accessories p.62 to 63

Modularity - Completely adaptable to all your needs - See p.49



Tents

Thule Panorama

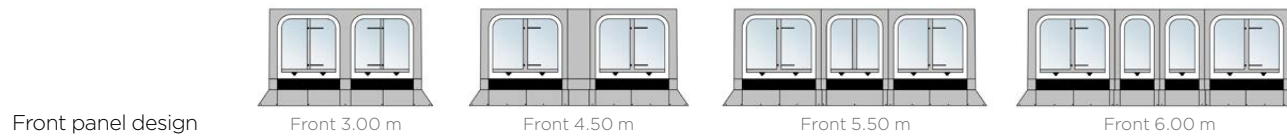

Clamping profile -
To mount and connect the side
panel to the awning fabric.

**Permanent aeration
on both sides**

Robust insulation -
A double rubber flap
attached to the mast
profile ensures full sealing
with the vehicle wall.

Mosquito mesh

Fabric - Made out of Airtex.

Installation - The side panels easily
slide into the clamping profiles
and the front panel slides into the
awning lead rail. Optimal closing
due to zipper connecting the front
and side panels.

Stability - A diagonal support
between the mast and the clamping
profile provides extra sturdiness.



User
instruction



Modularity



INCLUDED

- Windslip: prevents the wind from entering through the gap below your vehicle
- 2 luxury storage bags



Tents

Thule Residence G3

A real living room in the outdoors

The Thule Residence G3 awning tent is available in different sizes depending on your Thule Omnistor awning type, projection and mounting height. Special model available for a Volkswagen T5/T6 Multivan in combination with the Thule Omnistor 5102 awning.

Installation

The tent is delivered with clamping profiles to mount the side panels and connect them with the awning fabric for a perfect roof sealing. The side panels slide into the clamping profiles and the front panel slides into the awning lead rail. Both panels are combined with black double-shaped profiles for optimal closing.

Fabric material

High quality welded PVC fabric for optimal wind and water tightness in the colours black, grey and white.



Add to your Thule Residence G3



Thule Front Connection Profiles

301567 - Double-shaped connection profiles to slide in the integrated rope attached at the upper side of the front panel. Possible to slide a Thule Sun Blocker G2 in to create shade.

See more accessories p.62 to 63

Modularity - Completely adaptable to all your needs - See p.49



Tents

Thule Residence G3



Front panel design



Front 3.00 m to 3.25 m

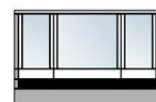

Front 3.50 m to 4.50 m



Front 5.00 m to 6.00 m

Permanent aeration on both sides

Clamping profile -

To mount and connect the side panel to the awning fabric.

Robust insulation -

A double rubber flap attached to the mast profile ensures full sealing with the vehicle wall.

Protection - The side

windows are in mosquito mesh covered with an external transparent blind to protect against rain.

Installation - The side panels easily slide into the clamping profiles and the front panel slides into the awning lead rail. Optimal closing due to double-shaped profiles connecting the front and side panels.

Stability - A diagonal support between the mast and the clamping profile provides extra sturdiness.

Fabric - Made out of PVC.



User instruction



Modularity

INCLUDED

- Windslip: prevents the wind from entering through the gap below your vehicle (included with front panel)
- 2 luxury storage bags (included with side panels)



NOTE - Front and side panels need to be ordered separately

Tents

Thule Residence G3 for Eriba Touring



New

A real living room in the outdoors

Special Thule Residence G3 model for Eriba Touring caravans in combination with the Thule Omnistor 6300 roof awning with length 3.25 m.

Installation

The tent is delivered with clamping profiles to mount the side panels and connect them with the awning fabric for a perfect roof sealing. The side panels slide into the clamping profiles and the front panel slides into the awning lead rail. Both panels are combined with black double-shaped profiles for optimal closing.

Fabric material

High quality welded PVC fabric for optimal wind and water tightness in the colours black, grey and white.

Modularity

The front panel has a door opening on the right side and can be rolled upwards separately for easy entrance. It is possible to add accessories in the optional rail at the front panel.



Perfect sealing



A foam with strap guarantees full sealing with the vehicle wall to avoid the wind from entering.

INCLUDED

- Windslip and wheelcover: prevent the wind from entering through the gap below your vehicle
- Storage bag



See accessories p.62 to 63



Tents

Thule Residence G3 for Volkswagen T5/T6



A real living room in the outdoors

Special Thule Residence G3 model for Volkswagen T5/T6 Multivan in combination with the Thule Omnistor 5102 awning or the original VW awning.

Installation

The tent is delivered with clamping profiles to mount the side panels and connect them with the awning fabric for a perfect roof sealing. The side panels slide into the clamping profiles and the front panel slides into the awning lead rail. Both panels are combined with black double-shaped profiles for optimal closing.

Fabric material

High quality welded PVC fabric for optimal wind and water tightness in the colours black, grey and white.

Modularity

The front panel has a door opening on the right side and can be rolled upwards separately for easy entrance. It is possible to add accessories in the optional rail at the front panel.



Perfect sealing



A foam with strap guarantees full sealing with the vehicle wall to avoid the wind from entering.

INCLUDED

- Windslip and wheelcover: prevent the wind from entering through the gap below your vehicle
- Storage bag



See accessories p.62 to 63



Tents

Thule QuickFit

Universal fitting on awnings with a projection from 2.50 m

The Thule QuickFit awning tent is available in 3 standard lengths, suitable for different mounting heights and has a special model for the Ducato H2 van.

Installation

The tent is in one piece and doesn't need additional fixation profiles. It easily slides into the caravan rail or into an additional rail below the awning cassette, and is fixed to the awning lead rail. The front canopy is installed with flexible arch tubes to provide additional shade.

Fabric material

Made out of Ripstop fabric: a lightweight woven and tear-resistant material used for aeronautical engineering. This material also has a strong water resistant coefficient. Because the tent is connected with an awning, the double roof offers a good insulation to keep the tent and vehicle cool.



Add to your Thule QuickFit



Thule Mosquito

Zippable panel to replace the standard front or side of the Thule QuickFit tent. Made of mosquito mesh to create additional ventilation.



Thule Side Tensioning Kit

307053 - Set of 2 fiberglass poles to ensure a better sealing of the Thule QuickFit tent with the vehicle wall.

See more accessories p.62 to 63

Modularity - Completely adaptable to all your needs - See p.49



Tents

Thule QuickFit



Fast and easy set up

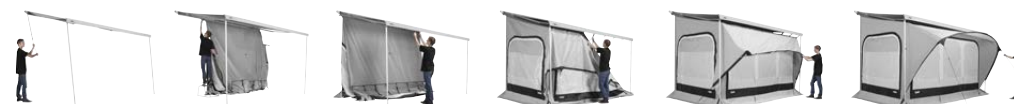

Double ceiling -

Created by suspending the tent below the awning fabric to ensure a better ventilation and insulation.

Mosquito mesh

Curtains with zippers

Fabric - Made out of Ripstop.

Fixation - The tent is connected to the black fixation parts, which are slid into the awning lead rail.

Ventilation - Two permanent ventilation openings allow a perfect air circulation when the tent is closed. The side windows are provided with mosquito mesh.



User instruction



Modularity



INSTALLATION

Fits into the caravan rail or into an optional rail
See p.62 - Installation Kits

INCLUDED

- Windslip: prevents the wind from entering through the gap below your vehicle
- Curtains with zippers
- Storage bag

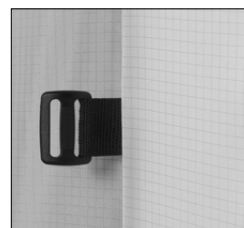









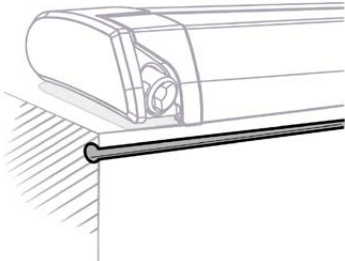

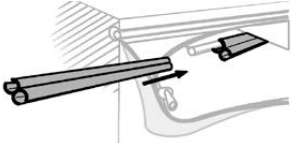
NOTE - There is no need to cover the full awning length.
The tent can easily be combined with Smart Panels

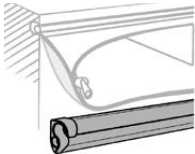
Tents - Accessories

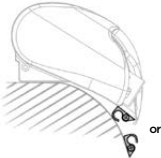
Installation kits for Thule QuickFit awning tents

For the installation of the Thule QuickFit awning tent, a caravan rail must be present to slide the tent in. When this is not the case an additional rail is needed. Thule created different ways to easily mount this awning tent on your awning.

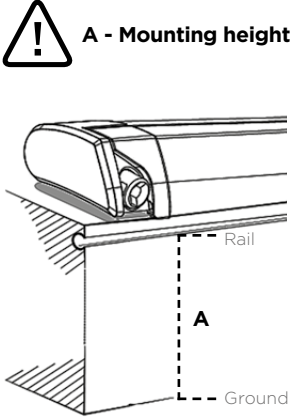
	Roof	Wall	Rail
Caravan			
	Original Caravan Rail All roof awnings 	Thule Universal Tent Fixation Kit All wall awnings 307205 307206 	Thule Awning Fixation Kit TO 1200 Only TO 1200 307063 
		Thule Tent LED Mounting Rail TO 5200 Only TO 5200 3012XX 	Thule Universal Tent Fixation Kit All bag awnings 307205 307206 
Motorhome - Van			
 	Thule Universal Tent Fixation Kit All roof awnings 307205 307206 	Thule Universal Tent Fixation Kit All wall awnings 307205 307206 	
	Thule Awning Fixation Kit TO 6300/6200/9200 Only TO 6300/6200/9200 307050 	Thule Tent LED Mounting Rail TO 5200 Only TO 5200 3012XX 	
	Thule Tent LED Mounting Rail TO 6300/6200/9200 Only TO 6300/6200/9200 301664 		 <p>A - Mounting height</p> <p>A = Distance between tent rail and ground</p>



Thule Mosquito

Thanks to the modularity of the Thule Panorama and QuickFit tent, all panels can be unzipped and replaced by a panel made of mosquito mesh to create ventilation and to keep dirt and vermin out.

Thule Panorama

- 309930 - Thule Mosquito Side
- 309931 - Thule Mosquito Front 4.00 - 6.00 m

Thule QuickFit

- 309925 - Thule Mosquito Side
- 309926 - Thule Mosquito Front 2.60 m
- 309927 - Thule Mosquito Front 3.00 m | 3.10 m
- 309928 - Thule Mosquito Front 3.60 m



Thule Hold Down Side Strap Kit

307916 - This kit prevents the awning and tent from being damaged due to high wind. The straps are attached to both awning support legs.

Tents - Accessories



Thule Universal Tent Fixation Kit

4.00 m caravan rail to be glued on the awning cassette or the vehicle wall for the installation of the Thule QuickFit tent.

307205 White 307206 Anthracite



Thule Tent LED Mounting Rail TO 6300 | 6200 | 9200

301664 - This 4.00 m profile can be slid at the bottom of TO 6300 | 6200 | 9200 roof awning cassettes. Provided with a channel to slide the Thule QuickFit tent in.



Thule Front Connection Profiles

301567 - Double-shaped connection profiles to slide in the integrated rope attached at the upper side of the Thule Residence G3 front panel. Possible to slide a Thule Sun Blocker G2 in.



Thule Awning Fixation Kit TO 1200

307063 - Double-shaped PVC profiles to slide in the integrated rope attached at the inner side of bag awning Thule Omnistor 1200 for the installation of the Thule QuickFit tent.



Thule Projection Kit

307052 - 8 buckles with strap to mount the Thule QuickFit tent on awnings with a projection from 2.75 to 3.00 m.



Thule Curtains

Easily create more privacy by adding curtains. Different sizes available depending on tent type, in the colour grey.



Thule Awning Fixation Kit TO 6300 | 6200 | 9200

307050 - 3 profiles to slide into the opening below the awning cassette TO 6300 | 6200 | 9200. It's glued to prevent sliding. Cannot be combined with a Thule LED Mounting Rail (306777).



Thule Side Tensioning Kit

307053 - Set of 2 fiberglass poles to ensure a better sealing of the Thule QuickFit tent with the vehicle wall.



Thule Tent LED Mounting Rail TO 5200

This aluminium profile covers the adapters of Thule Omnistor 5200 wall awning and is provided with a channel to slide the Thule QuickFit tent in.



Thule Awning Fixation Kit Fiamma

307061 - 8 fixation parts to slide into the front lead rail of Fiamma awnings (5 mm) to mount the Thule QuickFit tent.

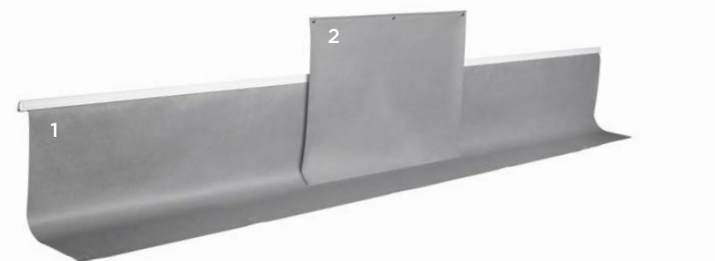

1 - Thule Windslip

Durable PVC windslip with a sewn kador to close the gap between the vehicle and the ground to prevent the wind from entering.

2 - Thule Wheelcover

307397 - Durable PVC wheelcover to cover your wheel to prevent the wind from entering.





› Bike Racks

No matter which vehicle you have and regardless the type and number of bikes you want to take along, there is a Thule bike rack that perfectly matches your needs and that will exceed your expectations.

Why choose a Thule Bike Rack?



Safe and high quality

Thule bike racks are extremely safe for several reasons: made of the highest quality materials, tested to the highest standards in the market and equipped with integrated safety features such as: a platform lock system, shock absorbing components, bike holders with integrated or optional locks, ...

A leading brand in bike racks for years



Load advice

- Load the heaviest bike first and closest to the vehicle
- The lightest bike should be fixed outwards
- Set the bikes crosswise on the carrier to find the best position, rotate the steering wheel 90° if needed
- Always secure all bikes to the bike rack frame using the included safety strap

Appealing design

Thule bike racks distinguish themselves by their contemporary design that perfectly matches any vehicle.

Thule Bike Holders with AcuTight Lock

As from January 2020, most RV bike holders will be replaced. The new bike holders will be provided with a lockable Thule AcuTight torque limiter knob that clicks when optimal torque is reached.

For models:

- Thule Excellent - Thule Elite G2 - Thule Caravan Superb / Superb XT / Smart - Thule Lift V16



Thule Test Center™

Thule Test Program™ as part of the development process. Product go through extreme testing before they can bear the Thule logo.



Smart innovations

Each Thule bike rack has smart innovative features making them easy to use and simple to install: wheel holders with pump buckle tensioning system, ergonomic Tilt-Lock system, sliding rails, fast click connections, ...



Bike holders

Soft touch bike holders with integrated or optional locks.



Platform lock system

Lockable platform to avoid movement during transport.



Pump buckle tensioning system

Easy, secured fastening of the bike wheels.



Tilt-Lock system

Easy to lock the tiltable platform onto the base frame.

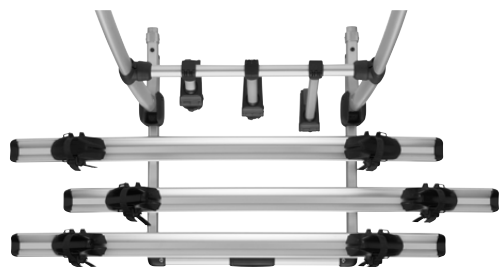

Sliding rails

Sliding rails make it easier to find the best position for your bikes.



Fast click connections

Fast click connections make the installation easier and faster.



Designed for outdoor adventures

Add some attitude to your recreational vehicle with the Thule bike rack range in black. The black aluminum frame is paired with black bike holders, creating a bike rack with a design language of its own – and features that will take your bikes anywhere. Made for people who want to have a bike rack with a sporty look.



Thule Excellent Black

See p.74



Thule Caravan Superb XT Black

See p.88



Thule Elite Van XT Black

See p.94



Bike Racks - Line at-a-glance

Rear Wall-mounted Bike Racks



Thule Lift V16



2 bikes, extendable to 3



Thule Excellent



2 bikes, extendable to 4



Thule Elite G2



2 bikes, extendable to 4



Garage-mounted Bike Racks



Thule VeloSlide



2 bikes



Thule Sport G2



2 bikes, extendable to 3



Thule Sport G2 Tour



2 bikes, extendable to 3



Thule Sport G2 Hobby



2 bikes, extendable to 3



Thule Sport G2 Universal



2 bikes

Bike Racks - Line at-a-glance

Garage-mounted Bike Racks



Thule Sport G2 Garage



2 bikes, extendable to 4

Rear Door-mounted Bike Racks



Thule Elite Van XT



2 bikes



Thule Sport G2 Compact



2 bikes



Thule WanderWay



2 bikes, extendable to 4



A-frame-mounted Bike Racks



Thule Caravan Superb



2 bikes, extendable to 3



Thule Caravan Superb XT Black



2 bikes, extendable to 3



Thule Caravan Smart



2 bikes



Thule Caravan Light



2 bikes

Rear Wall-mounted Bike Racks

Thule Lift V16

Bike rack with a height-adjustable platform

This bike rack is attached to the rear wall of a motorhome or caravan and is suitable for the transport of two (electric) bikes thanks to its load capacity up to 50 kg.

Easy load and unload

The platform of the bike rack can be lowered by means of a crank, which makes it easier to load and unload the bikes. Choose the motorised version for more ease of use. The 12V motor lowers the platform in just 40 seconds.

Safe and stable

Loading and securing the bikes takes no effort thanks to the lowered platform. The adjustable wheel holders keep your bikes in position and are easy to tighten with the straps with pump buckle tensioning system so that the bike wheels are securely fastened. The bike holders are attached to the bike frames and are lockable to prevent theft. You can transport a third bike by adding the optional rail kit.



Add to your Thule Lift V16



Thule Lift V16 3rd Rail Kit

307370 - To position a 3rd bike on the bike rack.



Thule Lift V16 Elongation Kit

307371 - Makes it possible to extend the mounting range to 95-150 cm.

See more accessories p.98 to 99



Rear Wall-mounted Bike Racks

Thule Lift V16



Lockable platform - The platform lock creates excellent dynamic force control and perfectly secures the bikes during transport. The platform is locked manually and can easily be clicked in the upwards position when not in use.

Bike holders - Easy mounting of bikes through detachable bike arms with lockable Thule AcuTight torque limiter knobs that click when optimal torque is reached.

Pump buckles - The straps with pump buckle tensioning system easily secure the bike wheels.

Loading - The platform can bridge a distance of 70 cm in height which makes loading and unloading the bikes easy.

Wheel holders - Finding the perfect position for your bike is easy thanks to the adjustable wheel holders. They enable you to transport all kinds of bikes with various sizes.

Closed platform



Open platform



Thule Lift V16 Manual



307368 - 2 bikes, extendable to 3

Thule Lift V16 Motor 12V



307369 - 2 bikes, extendable to 3



User
instruction



Rear Wall-mounted Bike Racks Thule Excellent

Elegant bike rack with a large load capacity

This bike rack is attached to the rear wall of a motorhome or caravan and is available in two models: a standard and short version. Both carriers are perfectly suitable for both regular bikes, mountain bikes and e-bikes thanks to their load capacity up to 60 kg.

For each bike

The wide rails are slidable both in depth and from left to right to find the best position for your bikes. The adjustable wheel holders keep your bikes in position and are easy to tighten with the straps with pump buckle tensioning system to firmly secure the bike wheels. The bike holders are attached to the bike frames and are lockable to prevent theft. You can transport a third or fourth bike by adding the corresponding optional rail kits.

Finish in black

The standard model is now available completely in black for a sleek and modern look and is extendable with a third and fourth bike with the optional rail kits.

Add to your Thule Excellent



Thule Excellent 3rd Rail Kit

To position a 3rd bike on the bike rack. Adjustable in all directions.

 309823
Anodised

 302034
Black



Thule Excellent 4th Rail Kit

To position a 4th bike on the bike rack. Fixed outwards and is not adjustable.

 309824
Anodised

 302035
Black

See more accessories p.98 to 99



Rear Wall-mounted Bike Racks Thule Excellent



Extra strong aluminium guarantees stability and reliability.

Bike holders - Easy mounting of bikes through detachable bike arms with lockable Thule AcuTight torque limiter knobs that click when optimal torque is reached.

Sliding rails - The rails are adjustable in depth and from left to right.

Thule Excellent - Black

Lockable platform - The platform lock creates excellent dynamic force control and perfectly secures the bikes during transport. The platform is locked automatically and can easily be clicked in the upwards position when not in use.

Pump buckles - The straps with pump buckle tensioning system easily secure the bike wheels.

Wheel holders - Finding the perfect position for your bike is easy thanks to adjustable wheel holders. They enable you to transport all kinds of bikes with various sizes.

Thule Excellent Standard

Thule Excellent Short



Thule Excellent Standard

🚲🚲 + 🚲 + 🚲
2 bikes, extendable to 4

309821
Anodised
302033
Black

Thule Excellent Short

🚲🚲 + 🚲 + 🚲
2 bikes, extendable to 4

309822
Anodised



User instruction

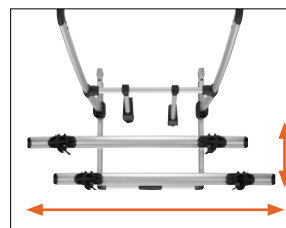

Rear Wall-mounted Bike Racks Thule Elite G2

The perfect all-round bike rack

This bike rack is attached to the rear wall of a motorhome or caravan and is available in two models: a standard and short version. Both carriers can transport up to 4 bikes with a load capacity up to 60 kg.

Load of the bike

Thanks to the sliding rails you can easily find the best position for your bikes. The bike wheels are securely fixed with straps to avoid movement during transport. The bike holders are attached to the bike frames and are optionally lockable to avoid theft. You can take a third or fourth bike with you by adding the optional rail kits.



Add to your Thule Elite G2



Thule Elite G2 3rd Rail Kit

306565 - To position a 3rd bike on the bike rack. Adjustable from left to right.



Thule Elite G2 4th Rail Kit

309824 - To position a 4th bike on the bike rack. Fixed outwards and is not adjustable.

See more accessories p.98 to 99



Rear Wall-mounted Bike Racks

Thule Elite G2

Extra strong aluminium guarantees stability and reliability.

Bike holders - Easy mounting of bikes through detachable bike arms with lockable Thule AcuTight torque limiter knobs that click when optimal torque is reached.

Sliding rails - The rails are adjustable from left to right. They easily slide to make sure you find the best position for your bikes without effort.

Thule Elite G2 Standard



Thule Elite G2 Short

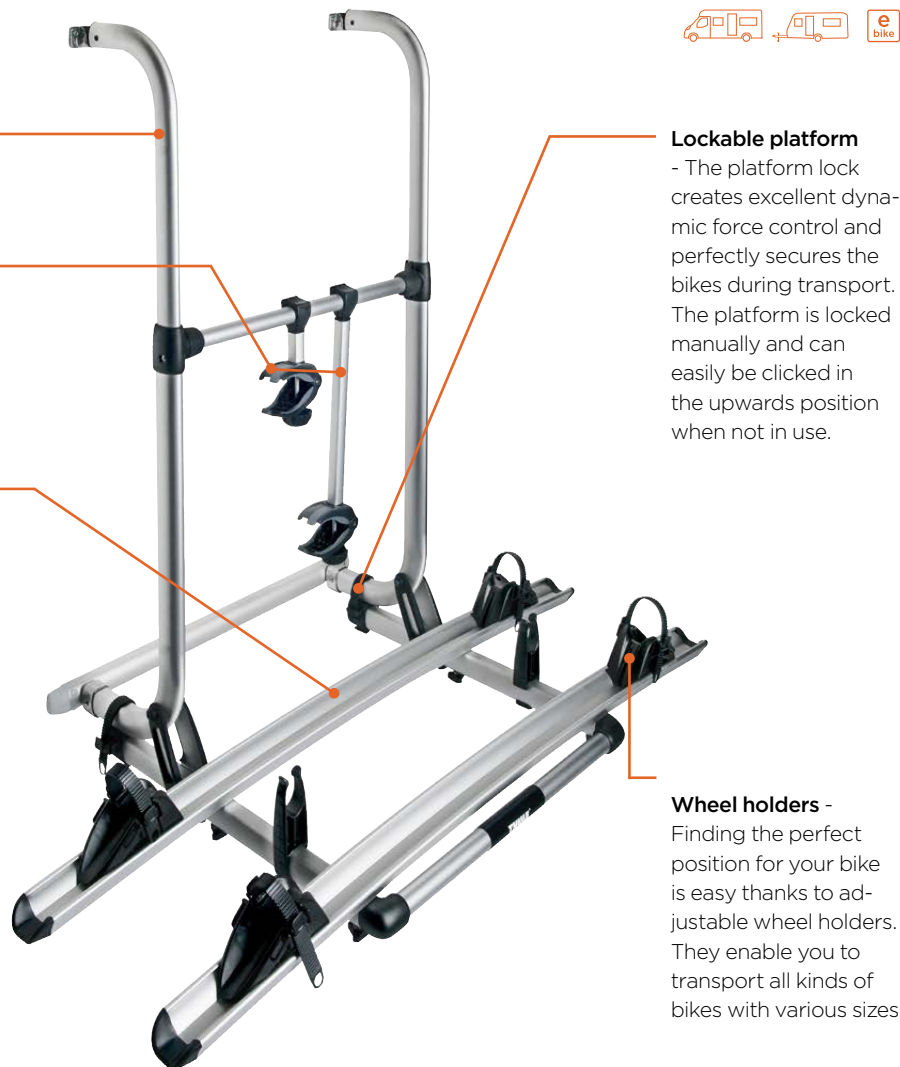

Lockable platform - The platform lock creates excellent dynamic force control and perfectly secures the bikes during transport. The platform is locked manually and can easily be clicked in the upwards position when not in use.

Wheel holders - Finding the perfect position for your bike is easy thanks to adjustable wheel holders. They enable you to transport all kinds of bikes with various sizes.



Thule Elite G2 One Bike



This model is the same as the standard bike rack with a shorter platform dedicated to transport only one bike with a maximum load capacity of 30 kg. This bike rack has been especially developed to meet the needs of the caravan user to aim for an equal load of two bikes on the caravan: one bike on the rear wall of the vehicle and one on the A-frame.

Thule Elite G2 One Bike

302047 - 1 bike

Thule Elite G2 Standard

+ + + 306560 - 2 bikes, extendable to 4

Thule Elite G2 Short

+ + + 306561 - 2 bikes, extendable to 4

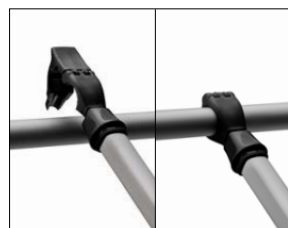
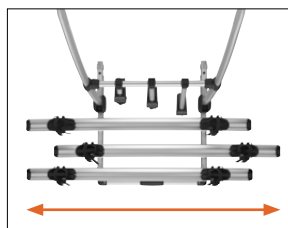

Rear Wall-mounted Bike Racks Thule Sport G2

Large range of bike racks for active lives

Find the perfect bike rack for your vehicle type. The Thule Sport G2 bike racks are attached to the rear wall of a motorhome or caravan and are available in different models. With a load capacity up to 50 kg you can easily transport 3 bikes.

Load of the bike

Thanks to the sliding rails you can easily find the best position for your bikes. The bike wheels are securely fixed with straps to avoid movement during transport. The bike holders are attached to the bike frames and are optionally lockable to avoid theft. You can take a third bike with you by adding the optional rail kit.



Add to your Thule Sport G2



Thule Sport G2 3rd Rail Kit

306577 - To position a 3rd bike on the bike rack.

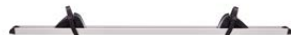

Thule E-bike Rail Kit

306945 - To transport one e-bike on a Thule Sport G2 bike rack.

See more accessories p.98 to 99



Rear Wall-mounted Bike Racks

Thule Sport G2



Extra strong aluminium guarantees stability and reliability.

Lockable platform -

The platform lock creates excellent dynamic force control and perfectly secures the bikes during transport. The platform is locked manually and can easily be clicked in the upwards position when not in use.

Thule Sport G2 Standard



Thule Sport G2 Short

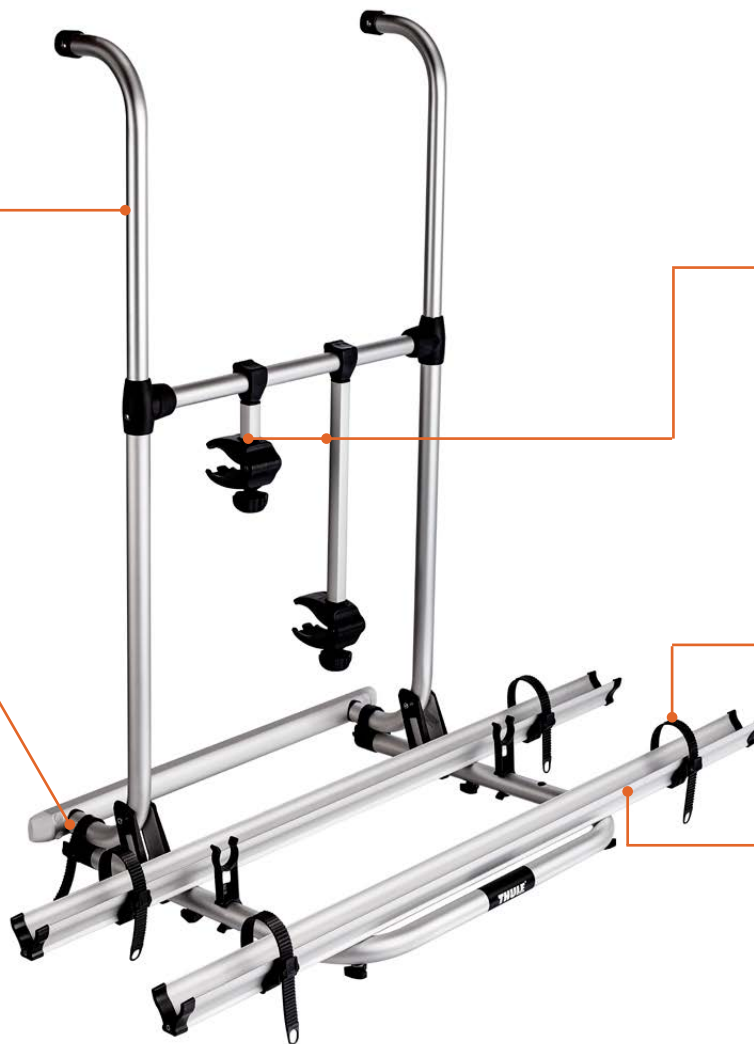

Bike holders - Adjustable soft-touch bike holders can easily be repositioned to align with the bike frame. The bikes can be secured with optional knobs with key lock.

Straps - The straps block the bike wheels to avoid movement during transport.

Sliding rails - The rails are adjustable from left to right. They easily slide to make sure you find the best position for your bikes without effort.

Thule Sport G2 Standard



307126 - 2 bikes, extendable to 3

Thule Sport G2 Short



307127 - 2 bikes, extendable to 3

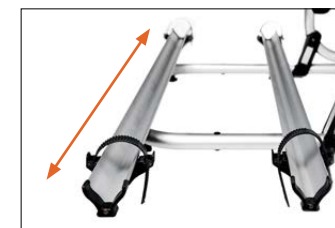
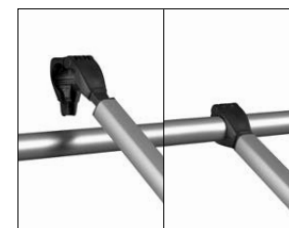

Rear Wall-mounted Bike Racks



Thule Sport G2 Tour

Possible to mount on a curved rear wall of a caravan or motorhome.

FEATURES

- Load capacity up to 50 kg
- Bike holders with optional locks
- The rails are adjustable from left to right
- The straps block the bike wheels to avoid movement during transport



306572 - 2 bikes, extendable to 3

Add to your Thule Sport G2 Tour



Thule Sport G2 3rd Rail Kit

306577 - To position a 3rd bike on the bike rack.



Thule Sport G2 Hobby

Suitable for Hobby caravans since 2004.

FEATURES

- Load capacity up to 50 kg
- Bike holders with optional locks
- The rails are adjustable from left to right
- The straps block the bike wheels to avoid movement during transport



307128 - 2 bikes, extendable to 3

Add to your Thule Sport G2 Hobby



Thule Sport G2 3rd Rail Kit

306577 - To position a 3rd bike on the bike rack.



NOTE - Special adapters available for Hobby caravans as from 2014 and 2015



Thule Sport G2 Universal

Recommended when space is limited by a window or a bumper. Attached under the base of the caravan.

FEATURES

- Load capacity up to 38 kg
- Bike holders with optional locks
- The rails are adjustable from left to right
- The straps block the bike wheels to avoid movement during transport



306563 - 2 bikes

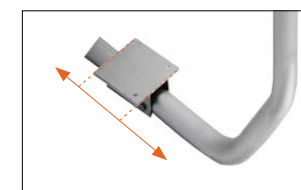



Garage-mounted Bike Racks

Thule VeloSlide

The smartest and most user-friendly bike rack for your RV garage space

With Thule VeloSlide, you get an ideal rack for transporting up to two e-bikes on your travels, using your RV's garage space to store them securely and protect them from the weather.

Loading and unloading couldn't be easier

When loading, the bike rack slides out up to 1.5 meter so you can lift your bike from the outside without having to bend awkwardly into the garage space. Thanks to the unique, patented and easy-to-grip handle, you can slide the rack into the garage space and automatically lock it securely - all with just one hand. When attaching your bikes to the rack you can easily optimise the position of each bike, both horizontally and vertically, with simple intuitive handlings even while the bike is on the rack and with no need for tools.

High-quality design

Thanks to the high-quality design and materials, you can be sure of safe, secure transportation of your valuable e-bikes, not to mention comfortable loading and unloading of heavy bikes - even when the bike rack is fully extended by 1.5 meter.



Add to your Thule VeloSlide



Thule Bike Frame Adapter

982003 - Frame adapter for easiest possible fitting of bikes with non-standard frames (e.g. ladies' bikes, downhill bikes).



Thule Brake Straps

306566 - By pulling the brakes, sideways movement is prevented and the bikes are more secured on the bike rack.

See more accessories p.98 to 99



Garage-mounted Bike Racks

Thule VeloSlide



New

Position bike - Bike's ideal position can be optimised without tools - even while the bike is already attached to the rack.

One-handed control - Unique and patented one-handed control.

Convenient handling - The bike rack slides out up to 1.5 meter. Comfortable handling of the bikes, all done while standing outside.

Thule VeloSlide Short

Overall length is 1.80 m; 15 cm shorter than the regular Thule VeloSlide. The bike rack slides out up to 1.35 m.

Bike holders - Adjustable soft-touch bike holders can easily be repositioned to align with the bike frame.

Mounting rails - The rack takes little space when not in use, it can be slid to the side or removed completely only leaving the mounting rails on the garage floor.

Thule VeloSlide



302014 - 2 bikes

Thule VeloSlide Short



302044 - 2 bikes

New

Mounting

The bike rack is attached to the garage floor with mounting rails - sold separately.

302015 - Mounting Rails: 70 cm

302016 - Mounting Rails: 140 cm



User instruction



NOTE - Please make sure your RV garage is high enough for your bikes

Garage-mounted Bike Racks

Thule Sport G2 Garage



Fixed inside the garage compartment

The Thule Sport G2 Garage bike rack is fixed to the inside wall and to the garage floor and is extendable to transport up to 4 bikes. The bike rails easily slide to make sure you find the best position for your bike. Secure your bike frame with the bike holders and the bike wheels with the straps to avoid movement during transport.

Solid attachment of the bike rack to the inside wall and floor of your garage space.



Add to your Thule Sport G2 Garage

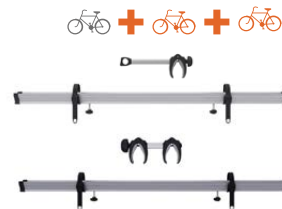

Thule Sport G2 3rd + 4th Rail Kit

306577 - To position a 3rd bike on the bike rack.

306578 - To position a 4th bike on the bike rack.

See more accessories p.98 to 99

The platform can easily be clicked in the upwards position when not in use.



306574 - 2 bikes, extendable to 4



A-frame-mounted Bike Racks Thule Caravan Superb

Perfect bike rack to transport two e-bikes on the A-frame

The Thule Caravan Superb is mounted on the caravan A-frame and is available in two models: a standard and short version. The standard version is suitable for normal A-frames and the short version is suitable for both short and normal A-frames. Perfect to take along two heavy bikes with a total load capacity of 60 kg. You can transport a third bike on the standard version by adding the optional rail kit.

Access to the front locker

Thanks to the unique Tilt-Stop system the bike rack is tiltable even with loaded bikes. The maximum angle to tilt the bike rack can be set as you please. In this way the front locker of the caravan remains accessible.



Add to your Thule Caravan Superb



Thule Caravan Superb 3rd Rail Kit

307131 - To position a 3rd bike on the bike rack. Only for Thule Caravan Superb Standard.



Thule Brake Straps

306566 - By pulling the brakes, sideways movement is prevented and the bikes are more secured on the bike rack.

See more accessories p.98 to 99



A-frame-mounted Bike Racks Thule Caravan Superb



Thanks to the adjustable Tilt-Stop system the maximum angle to tilt the bike rack can be set as you please.

Adjustable Tilt-Stop - Completely tiltable with bikes on providing easy access to the front locker of the caravan.

Thule Caravan Superb Standard

Thule Caravan Superb Short



Bike holders - Easy mounting of bikes through detachable bike arms with lockable Thule AcuTight torque limiter knobs that click when optimal torque is reached

Lockable platform - The low platform gives a better centre of gravity, which makes it safer to drive and much easier to load your bikes. The ergonomic Tilt-Lock system makes it easy to lock the tiltable platform onto the base frame by hand, without any loose parts.

Thule Caravan Superb Standard



307130 - 2 bikes, extendable to 3

Thule Caravan Superb Short



307329 - 2 bikes



User instruction



A-frame-mounted Bike Racks

Thule Caravan Superb XT Black

Design and functionality for an A-frame-mounted bike rack

This A-frame-mounted bike rack attracts the attention by its unique design in black and offers all the functionalities to transport your bikes in a simple and safe way. Available in a standard and short version. Both carriers are suitable for the transport of heavier bikes thanks to their load capacity of up to 60 kg.

Load of the bike

The adjustable wheel holders keep your bikes in position and are easy to tighten with the wheel straps with pump buckle tensioning system to securely fasten the bike wheels. The bike holders are attached to the bike frames and are lockable to prevent theft. You can take a third bike on the standard version by adding the optional rail kit.

Access to the front locker

Thanks to the unique Tilt-Stop system the bike rack is tiltable even with loaded bikes. The maximum angle to tilt the bike rack can be set as you please. In this way the front locker of the caravan remains accessible.



Add to your Thule Caravan Superb XT Black



Thule Caravan Superb XT 3rd Rail Kit Black

302032 - To position a 3rd bike on the bike rack.



Thule Brake Straps

306566 - By pulling the brakes, sideways movement is prevented and the bikes are more secured on the bike rack.

See more accessories p.98 to 99



A-frame-mounted Bike Racks

Thule Caravan Superb XT Black



Thanks to the adjustable Tilt-Stop system the maximum angle to tilt the bike rack can be set as you please.

Adjustable Tilt-Stop - Completely tiltable with bikes on providing easy access to the front locker of the caravan.

Thule Caravan Superb XT Black - Standard

Thule Caravan Superb XT Black - Short



Bike holders - Easy mounting of bikes through detachable bike arms with lockable Thule AcuTight torque limiter knobs that click when optimal torque is reached.

Wheel holders - Finding the perfect position for your bike is easy thanks to adjustable wheel holders. They enable you to transport all kinds of bikes with various sizes.

Lockable platform - The low platform gives a better centre of gravity, which makes it safer to drive and much easier to load your bikes. The ergonomic Tilt-Lock system makes it easy to lock the tiltable platform onto the base frame by hand, without any loose parts.

Thule Caravan Superb XT Black Standard



302031 - 2 bikes, extendable to 3

Thule Caravan Superb XT Black Short



302030 - 2 bikes



A-frame-mounted Bike Racks



Thule Caravan Smart

This compact and tiltable carrier can be mounted both on a normal or a short A-frame. Possible to transport one e-bike and one normal bike.

FEATURES

- Load capacity up to 50 kg
- Bike holders with lockable locks
- The straps block the bike wheels to avoid movement during transport
- Completely tiltable with bikes on



307129 - 2 bikes



Add to your Thule Caravan Smart



Thule Brake Straps

306566 - By pulling the brakes, sideways movement is prevented and the bikes are more secured on the bike rack during transport - set of 6.

See more accessories p.98 to 99



Thule Caravan Light

The foam prevents the bikes from being damaged during transport. The wheel and bike holder straps make it easier to fix the bikes.

FEATURES

- Load capacity up to 40 kg
- Partly tiltable, bikes need to be taken off to access the storage space



306598 - 2 bikes



Add to your Thule Caravan Light



Thule Bike Holder 1 with AcuTight Knob

302520 - Adjustable bike holder with lockable Thule AcuTight torque limiter knob that clicks when optimal torque is reached. For bike racks with tube diameter of 30 mm - length \pm 12 cm.

See more accessories p.98 to 99



Rear Door-mounted Bike Rack Thule WanderWay

Top of the line trunk bike rack for the VW T6 minivan

Thule WanderWay is quick and simple to mount, thanks to the dedicated fit to the VW T6 minivan (does not fit VW T5).

Load capacity

It carries two bikes and it is possible to increase the load capacity to carry up to 4 bikes by adding a 3rd bike and a 4th bike adapter. Alternatively, the robust construction lets you carry two e-bikes with a combined weight of up to 60 kg.

Easy to use, easy to keep on your car

Everything on the Thule WanderWay is designed for ease of use. Load your bikes easily with easy-to-adjust rails that slide from left to right, and fasten the wheels securely with wheel holders with pump buckles. Once mounted, Thule WanderWay can stay on your car for as long as you like – it is possible to open the vehicle trunk without any mounted bikes.



Add to your Thule WanderWay



Thule WanderWay 3rd Rail Kit

911600 - To position a 3rd bike on the bike rack. Adjustable from left to right.



Thule WanderWay 4th Rail Kit

911700 - To position a 4th bike on the bike rack.

See more accessories p.98 to 99



Rear Door-mounted Bike Rack Thule WanderWay



New

Mounting - Quick and simple to mount thanks to the dedicated fit to the VW T6 minivan. Possible to increase load capacity up to 4 bikes.

Bike holders - Easy mounting of bikes through detachable bike arms with lockable Thule AcuTight torque limiter knobs that click when optimal torque is reached.

Foldable platform - Platform folds up vertically when not in use and folds flat for easy transport and convenient storage.



Sliding rails - The rails are adjustable from left to right to easily find the best position for your bikes.

Wheel holders - Finding the perfect setting for your bike is easy thanks to the adjustable wheel holders. They enable you to transport all kinds of bikes with various sizes.

Thule WanderWay



911001 - 2 bikes, extendable to 4



Anodised/black



Rear Door-mounted Bike Racks Thule Elite Van XT

Lightweight bike rack with premium performance

The Thule Elite Van XT bike rack is very easy to install, it's clamped and glued on the rear door of the van and requires no drilling.

Two finishes

The bike rack is available in two finishes: anodised and black. The finish completely in black is perfect for vans with a sporty and off-road look.

Secure fastening

Adjustable wheel holders with straps with pump buckle tensioning system easily secure the bike wheels to avoid movement during transport. A distance of 20 cm between the rails enables a more easy load of the bikes. Doors can be opened with bikes on.

Perfect finish

Rubber sealing strips create a perfect finish even when the bike rack is taken off.



Add to your Thule Elite Van XT



Thule Strap Lock

307389 - Strap with a durable steel wire to bind around your bikes and bike rack to secure them during transport - length 3.00 m.



Thule Bike Frame Adapter

982003 - Frame adapter for easiest possible fitting of bikes with non-standard frames (e.g. ladies' bikes, downhill bikes).

See more accessories p.98 to 99



Rear Door-mounted Bike Racks Thule Elite Van XT



Thule Elite Van XT

2 bikes

Suitable for Ducato, Jumper and Boxer from 2007 onwards

307340
Anodised

302013
Black

Thule Elite Van XT

2 bikes

Suitable for VW Crafter from 2017 onwards

302018
Black

Thule Elite Van XT

2 bikes

Suitable for Sprinter as from 2006 and VW Crafter 05/ 2006-2017

302043
Black

New







Rear Door-mounted Bike Racks Thule Sport G2 Compact



Compact bike rack for vans

This compact bike rack is suitable for vans with double rear doors and for vehicles with curved surfaces thanks to a 4 point fixation system. Doors can be opened with bikes on.

NOTE - Not suitable for Ducato, Jumper and Boxer



307341 - 2 bikes



Add to your Thule Sport G2 Compact



Thule Knob with Lock
526000 - To replace the knob of bike holders without lock for extra security.

See more accessories p.98 to 99

Bike Racks - Accessories



Thule One-Key System

Install or replace all lock cylinders on your Thule products and use the same key for all.



Thule Strap Lock

307389 - Strap with a durable steel wire to bind around your bikes and bike rack to secure them during transport - length 3.00 m.



Thule Knob with Lock

To replace the knob of bike holders without lock for extra security.

- 526000 - set of 2
- 527000 - set of 4



Thule Wheel Adapter

977200 - Special protection for road bikes and mountain bikes. Placed between the strap and the rim - set of 2.



Thule Brake Straps

306566 - By pulling the brakes, sideways movement is prevented and the bikes are more secured on the bike rack during transport - set of 6.



Thule AcuTight Knob

528000 - To replace the knob of bike holders without AcuTight. Has a built in torque limiter that "clicks" when optimal hold is reached indicating correct mounting.



Thule Cable Lock

538000 - Strong, coated cable to secure your bikes - length 1.80 m.



Thule Bike Frame Adapter

982003 - Frame adapter for easiest possible fitting of bikes with non-standard frames (e.g. ladies' bikes, downhill bikes).



Thule Rear Warning Sign - Italian type

307619 - Officially approved aluminium rear reflecting panel for protruding loads. Suitable for Europe, except for Spain - 50 x 50 cm.



Thule Bike Cover

High quality bike cover to protect your bicycles during transport on a rear-mounted bike rack.

- 307335 - Suitable for 2/3 bikes
- 307336 - Suitable for 4 bikes



Thule Rear Warning Sign - Spanish type

307337 - Officially approved aluminium rear reflecting panel for protruding loads. Suitable for Spain, not for other European countries - 50 x 50 cm.

Bike Racks - Accessories



New

Thule Bike Holder 1 with AcuTight Knob

Adjustable bike holder with lockable Thule AcuTight torque limiter knob that clicks when optimal torque is reached. For bike racks with tube diameter of 30 mm - length ± 12 cm.

302520
Anodised

302525
Black



New

Thule Bike Holder 2 with AcuTight Knob

Adjustable bike holder with lockable Thule AcuTight torque limiter knob that clicks when optimal torque is reached.. For bike racks with tube diameter of 30 mm - length ± 26 cm.

302521
Anodised

302526
Black



New

Thule Bike Holder 2.5 with AcuTight Knob

Adjustable bike holder with lockable Thule AcuTight torque limiter knob that clicks when optimal torque is reached. For bike racks with tube diameter of 30 mm - length ± 30 cm.

302522
Anodised

302527
Black



New

Thule Bike Holder 3 with AcuTight Knob

Adjustable bike holder with lockable Thule AcuTight torque limiter knob that clicks when optimal torque is reached. For bike racks with tube diameter of 30 mm - length ± 41 cm.

302523
Anodised

302528
Black



New

Thule Bike Holder 4 with AcuTight Knob

Bike holder with lockable Thule AcuTight torque limiter knob to connect bike 3 with bike 4 - length ± 15 cm.

302524
Anodised

302529
Black



Thule Cover for Mounting Rail

307328 - Covers the holes in the mounting rails when the bike rack is dismantled from the vehicle to avoid dust and dirt - set of 2.



Thule E-bike Rail for Sport G2

306945 - Extra-long rail to transport 1 e-bike on a Thule Sport G2 bike rack - max. load of 30 kg.



Bike rack - Adapters

Thule has a large range of bike rack adapters available, developed in cooperation with and approved by the recreational vehicle manufacturers to fit any type of vehicle. Thule advises to let the installation be done by a professional.





› Storage

Space is always too tight, therefore a flexible storage is crucial. It allows you to have a place for each item and easy access to it. With our smart storage solutions you can store your things inside or outside your vehicle to fully enjoy your free time.



Storage - Line at-a-glance

Organizers



Thule Wall Organizer

14 pockets in 2 different sizes



Thule Shoe Organizer

10 large and 2 mesh pockets



Thule Countertop Organizer

Different compartments and elastic loops



Thule Go Box

2 main compartments and 3 side pockets



Thule Toiletry Kit

13 separate compartments



Thule Trash Bin

Suitable for plastic trash bags of 50 litres



Fixation systems

3 systems to hang up the organizers

Boxes



Thule Force XT

Roof-mounted box

Organizers



Thule Wall Organizer

Provides storage space for all kinds of things.

FEATURES

- 14 pockets in 2 different sizes
- Integrated cover with zipper to protect your items during transport
- Dimensions LxH: 50 x 85 cm

FIXATION (not included)

- Thule Strap Kit for Organizers
- Thule POD 2.0
- Thule POD 1.0

306924
Black/Grey

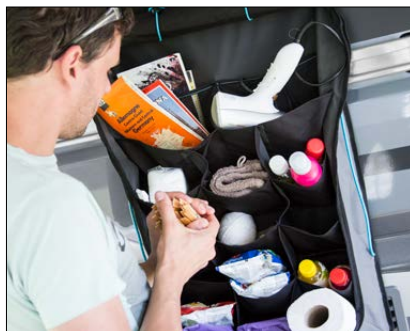

Thule Shoe Organizer

Provides storage space for at least 10 pairs of shoes.

FEATURES

- 10 large and 2 mesh pockets
- Integrated cover with zipper to protect your shoes during transport
- Dimensions LxH: 50 x 80 cm

FIXATION (not included)

- Thule Strap Kit for Organizers
- Thule POD 2.0
- Thule POD 1.0

306925
Black/Grey



Thule Countertop Organizer

Keeps all essential items within reach.

FEATURES

- Different compartments and elastic loops
- Integrated paper towel holder
- Dimensions LxH: 90 x 40 cm

FIXATION (not included)

- Thule Strap Kit for Organizers
- Thule POD 2.0
- Thule POD 1.0

306926
Black/Grey



Thule Go Box

Handy and foldable storage box in two sizes.

FEATURES

- 2 main compartments and 3 side pockets
- Simple to carry and it folds up quickly to store when not in use
- Foldable cap for rain protection
- Dimensions Medium LxWxH: 61 x 36 x 30 cm
- Dimensions Large LxWxH: 61 x 46 x 30 cm

M - 306929
Black/Grey

L - 306930
Black/Grey



Organizers



Thule Toiletry Kit

Ideal to use in the bathroom.

FEATURES

- 13 separate compartments
- Easy to carry thanks to the handle on top
- Removable mirror
- Dimensions closed LxH: 35 x 40 cm
- Dimensions opened LxH: 35 x 120 cm
- L-shaped hook to fit over doors

FIXATION (not included)

- Thule POD 2.0
- Thule POD 1.0

306928
Black/Grey



Thule Trash Bin

Keeps your waste or laundry out of sight and off the ground.

FEATURES

- Suitable for plastic trash bags of 50 litres
- A zipper at the bottom makes it easy to empty and clean
- Dimensions LxWxH: 35 x 35 x 70 cm

FIXATION (not included)

- Thule POD 1.0

306927
Black/Grey

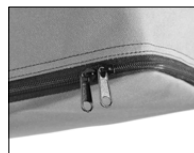

Fixation systems



Thule Strap Kit for Organizers

FEATURES

- Fits in the caravan rail or the front lead rail of the awning
- Maximum load: 10 kg/strap
- Quick release system
- Adjustable in height
- Strap length: 1.20 m
- Set of 2 pieces

307124
Black



Thule POD 2.0

FEATURES

- Mounted with two screws and/or glue
- Cover included
- Compact and discrete design
- Maximum load: 10 kg/POD
- Dimensions LxWxH: 5.5 x 1.2 x 3 cm
- Set of 2 pieces

306804
White



Thule POD 1.0

FEATURES

- Mounted with two screws
- Cover included
- Dimensions LxWxH: 8.8 x 4.4 x 5.2 cm
- Set of 2 pieces

307620
White





Roof-mounted box Thule Force XT



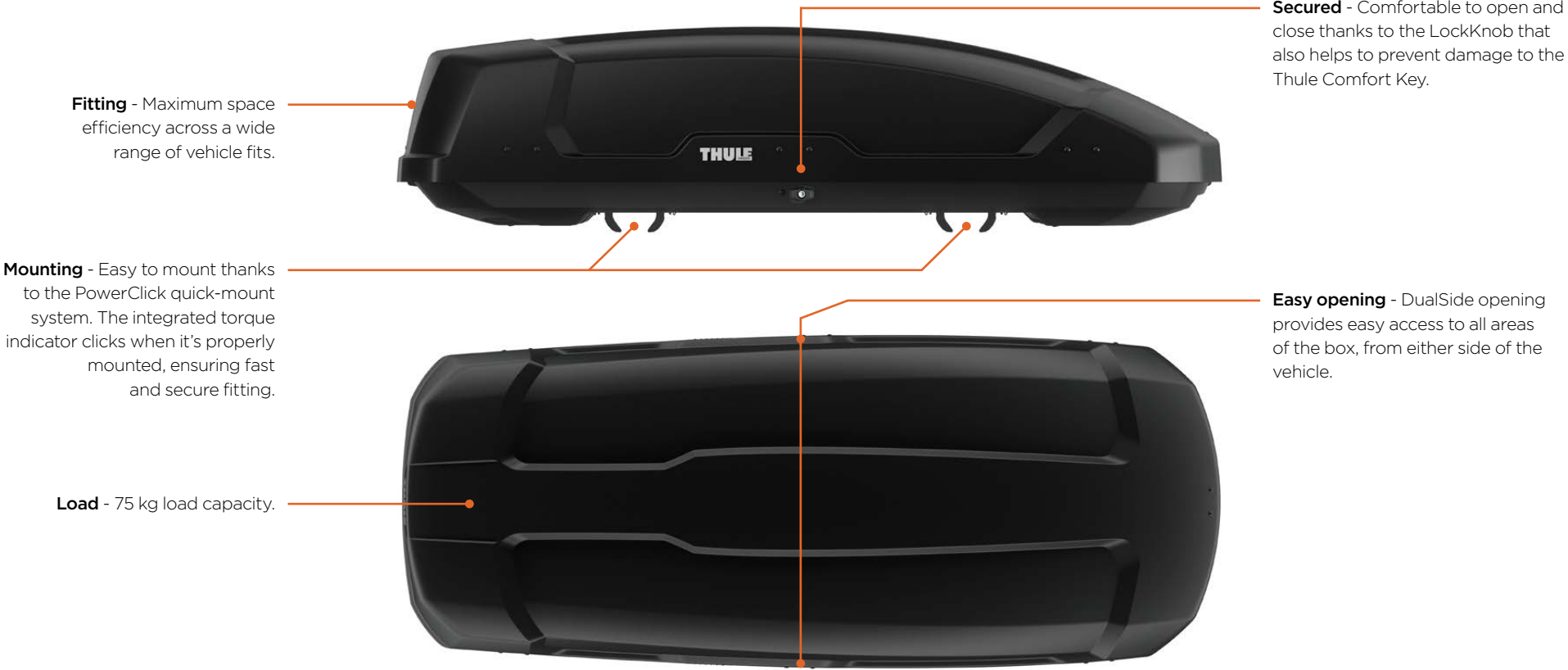

Versatile roof-mounted cargo box for everyday use



NOTE - When mounted on load bars Thule ProBar Flex use Thule T-Track Adapter 697600



S	M	L
 635100 Black Aeroskin	 635200 Black Aeroskin	 635700 Black Aeroskin

Discover more Thule roof box models on www.thule.com





› Comfort & Security

Make your holiday pleasant and comfortable. With a wide range of steps and ladders, access to your vehicle or roof is effortless. Enjoy your activities far from your vehicle with the knowledge your belongings are protected with robust, high quality locks.



Comfort & Security - Line at-a-glance

Roof rack system



Thule SmartClamp System



Thule Van Ladder 9 Steps



Thule Ladder Fixation Kit



Comfort



Thule Ladders



Thule Steps



Thule Vents



Security



Thule Levelers



Thule Locks



Roof rack system

Thule SmartClamp System

Easy-to-install roof rack base rails for vans*

This roof rack system is a versatile piece of equipment, that is emphasised by its wide range of additional accessories. Equipped with features allowing full optimisation for different activities, the strong endurance makes it possible to use during all seasons.

Thule SmartClamp System

Easy installation without drilling by mounting the smart clamps to the van's existing fix points. The two base rails are glued onto the vehicle roof and connected with the smart clamps to perfectly integrate with the vehicle roof.

Thule ProBar Flex

Option to add two or more load bars, allowing fitting of Thule ProBar roof accessories. The load bars can be positioned anywhere along the base rails in function of the combination of accessories on the roof. Available in 2 different heights and the load bars are lockable with a key to prevent theft.

Awning adapter

With or without the roof rack, the awning adapter can easily be mounted on the roof or on the roof rack without drilling. The adapter covers under the awning provide a complete finishing and integration with the vehicle.



Add to your Thule ProBar Flex



Thule Omnistor 6300

Create a shelter by expanding the roof rack with an awning. See p.24



Thule Force XT

Versatile roof-mounted cargo box for everyday use. See p.107

*Suitable for H2 Ducato | Jumper | Boxer vans from 2007 onwards



Roof rack system Thule SmartClamp System



Base rails - The load bars are mounted on two base rails which are glued and secured with smart clamps on the vehicle roof. Different lengths available for the different models.

Load bars - Flexible position of the load bars to avoid obstacles on the roof and for optimal fitting of accessories. Possible to add two or more load bars.

Smart Clamps - Innovative fastening pieces to install the base rails on the existing fix points of the vehicle without drilling.

NOTE - The roof should be clear of obstacles within 10 cm from the fix points

Thule ProBar Flex



Roof rack load bars for vans, allowing fitting of Thule roof accessories. Available in two different heights.

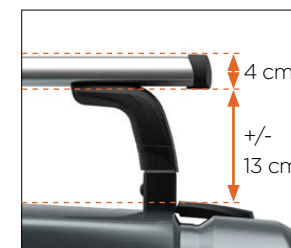

Thule ProBar Flex - High
Set of 2 high load bars.

301647
Aluminium

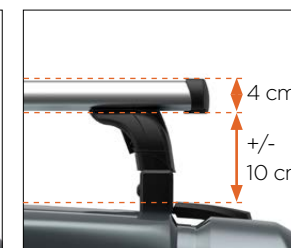

Thule ProBar Flex - Low
Set of 2 low load bars.

301648
Aluminium

NOTE - Maximum loading weight of 75 kg per set of load bars



Ladder for roof access Thule Van Ladder 9 Steps



Telescopic ladder for easy access to roof-mounted accessories

Easily fixed to the vehicle wall with extra stability thanks to the included magnetic fixation kit.

FEATURES

- Easy to use anywhere you want
- Safe and stable on most terrains
- The ladder is extendable to 2.60 m
- Open partly for lower reach
- Air pressure system for safe closing
- Compact when not in use
- Complies with EN-131



Soft-Close



301404
Anodised

INCLUDED

- Thule Van Ladder 9 Steps
- Thule Ladder Fixation Kit
- 4 protective patches
- 2 organizer fixation parts
- Storage bag for ladder
- Storage bag for fixation kit



Kit for wall fixation Thule Ladder Fixation Kit

Magnetic kit suitable for steel surfaces

Use the Thule Ladder Fixation Kit for extra stability when using a telescopic ladder. Apply the magnetic kit wherever you want on the vehicle and put the ladder against it. Bind the straps around the ladder and tension them by using the pump buckles.

FEATURES

- Easy to apply on and remove from steel surfaces
- Multi-purpose use for telescopic ladder, organizers and windscreen
- Safe storage

301405
Anodised

INCLUDED

- Thule Ladder Fixation Kit
- 4 protective patches
- 2 organizer fixation parts
- Storage bag

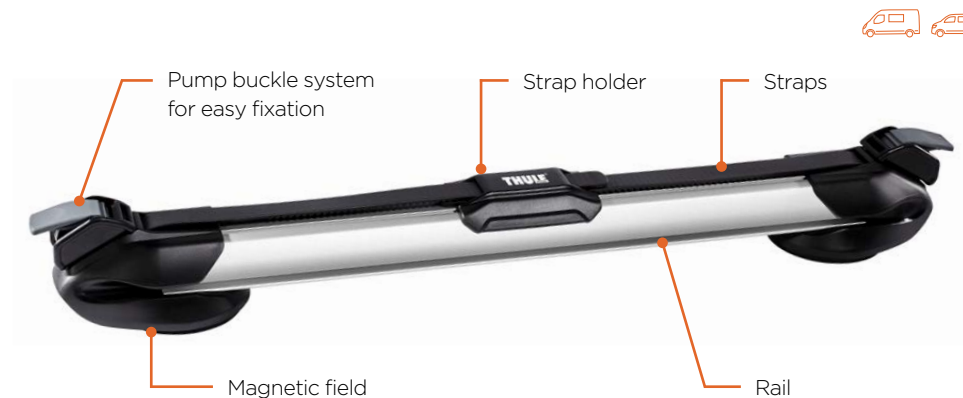

Add to your Thule Ladder Fixation Kit

Thule Windscreen - See p.43

Thule Organizers - See p.104



Discover all Thule van accessories in the “Product Guide - Van & minivan accessories” catalogue or go to www.thule.com.





Comfort Thule Ladders



Thule Ladder 4 Steps

FEATURES

- 4 steps
- Backside mounting on a van
- Round tubes

307490
Anodised



Thule Ladder 5 Steps

FEATURES

- 5 steps
- Indoor use
- Round tubes

307492
Anodised



Thule Ladder 6 Steps

FEATURES

- 6 steps
- Backside mounting
- Round tubes

307487
Anodised



Thule Ladder Deluxe 6 Steps

FEATURES

- 6 steps
- Backside mounting
- Oval arms

307496
White

Comfort Thule Ladders



Thule Ladder 10 Steps

FEATURES

- 10 steps
- Backside mounting
- Round tubes
- Foldable

307488
Anodised



Thule Ladder Deluxe 11 Steps

FEATURES

- 11 steps
- Backside mounting
- Oval arms
- Foldable

307497
White

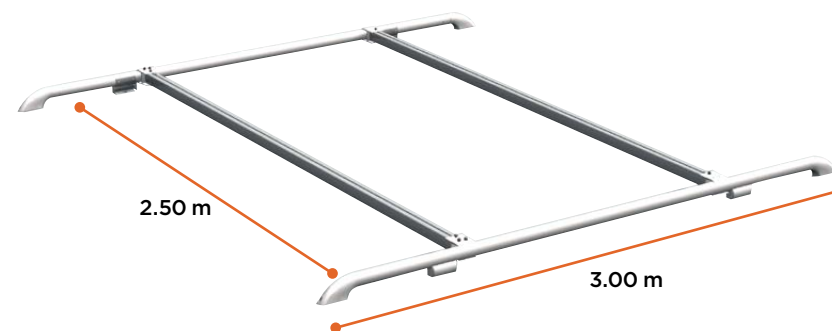

Roof rails with oval profiles

Standard length 3 meters, easy to adjust to the required length. Optional: set of 2 accompanying cross rails in aluminium with a standard length of 2.50 m. Loading capacity of 70 kg.

307516
Roof rails aluminium

307511
Roof rails white lacquered

307499
Cross rails

Comfort Thule Steps



Easy access to your vehicle

A step allows you to easily enter your vehicle without effort, operated manually or via motor.

High quality

Extremely robust, the steps are made of corrugated anodised aluminium. Their quality exceeds European quality standard EN1646.

Extra safety

A switch for the connection of a warning lamp inside the vehicle is included as standard, making it impossible to drive away with the step still out.

Motorised steps

For even greater convenience, opt for the motorised steps. Each model is operated by a simple switch conform to the EMV and CE norms.

LED: maximum visibility

To be clearly visible under all conditions, each motorised slide-out step can be equipped with the optional Thule LED Kit for additional lighting.

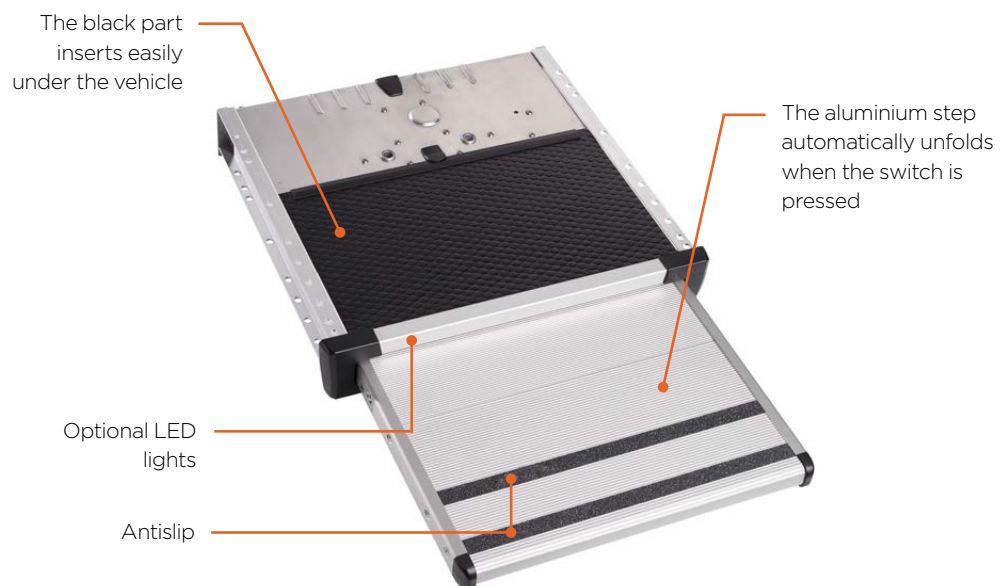

Motorised steps



Thule Slide-Out Step V18 12V

FEATURES

- Different installation sets for vans available
- Width: 400 - 550 - 700 mm



Thule Single Step 12V

FEATURES

- Width: 460 - 550 mm



Thule Double Step 12V

FEATURES

- Width: 380 - 440 - 500 mm



New

Thule Slide-Out Step V19 12V Ducato | Jumper | Boxer Euro 6d-Temp

FEATURES

- Mounting set bought separately
- Width: 400 - 550 - 700 mm



New

Thule Slide-Out Step V19 12V Crafter 2017

FEATURES

- Mounting set bought separately
- Width: 400 - 550 - 700 mm

Accessories for motorised steps

• Thule LED Kit for Slide-Out Step:

Integrated and protected LED for optimal visibility of the footboard

301477 - Thule LED Kit for standard Slide-Out Steps (700 mm)

301826 - Thule LED Kit for Ducato | Crafter Slide-Out Steps (700 mm)

- **Relay:** ensures that the step is folded up when the motor starts
- **Step control box:** ensures that the step is automatically folded and unfolded when the door is opened and closed

NOTE - Our products are designed and developed for use in the recreational sector. As such, our products have not been tested and are not warranted for use in semi-professional or professional applications like busses, taxis, ambulances, etc

Manual steps



Thule Slide-Out Step Manual

FEATURES

- Width: 400 mm



Thule Single Step Manual

FEATURES

- Width: 550 mm

Comfort Thule Vent - Manual



Practical for fresh and healthy air

Natural airing: use the Thule Vent as a window

An aerodynamic design means you no longer need a spoiler. The roof light is mounted with special clamps so drilling is not needed, except for the opening itself.

Mosquito screen

The Thule Vent model includes a removable mosquito screen on the outside to keep dirt and vermin out.



FEATURES

- Dimensions outside: 47.2 x 45.9 cm
- Dimensions inside: 40 x 40 cm
- Weight: 3 kg
- All materials are made of impact and weather-resistant plastics



Add to your Thule Vent

Thule Ventilator Kit 12V

211001 - The optional ventilator makes it possible to motorise your manual Thule Vent.



FINISHES



200004 - White



200016 - Translucent



200018 - Transparent

Comfort Thule Vent - Motorised



Practical for fresh and healthy air

Ventilation: combine the Thule Vent with a motorised ventilator

Provides fresh air and ventilation instantly. A simple press on the button of the control panel adjusts the speed and rotation direction. Plus, it is silent and extremely low on energy consumption.



FEATURES

- Motor 12V
- Max. 20 m³/min.
- Ventilation and extraction
- Connection with a thermostat or motion sensor is also possible
- Weight: 4.5 kg



Security

In addition to 12 ventilation speeds, the Thule Vent has an energy saving function, a boost function and a safety mechanism to guard against excess voltage, incorrect connection and blockage.



FINISHES



200063 - White



200061 - Translucent



200065 - Transparent

Security Thule Levelers

The stable way to park

Top stability

Thule levelers offer a very large surface area for increased stability, making them ideal for wider tyres, with a maximum load capacity of 5 ton/set.

Striped area

The three heights make it easier to get your vehicle leveled. The striped area offers perfect grip between the tyre and the leveler.



FEATURES

- 3 heights: 44 - 78 - 112 mm
- Dimensions LxWxH: 560 x 200 x 150 mm
- Weight: 1.8 kg per leveler

307617
Black

INCLUDED

- Set of 2 levelers
- Storage bag



Locks

Thule Security Handrail



Thule Security Handrail

This handrail has a unique double locking design for extra safety. In the open position it offers a sturdy grasp handle to help getting in and out the vehicle and in its locked position it folds across the door giving added visible security.

PACK

- 308892 - 1 piece
White
- 308893 - Thule Security Handrail Door Frame Kit
White



Thule Security Handrail - Short Version

This sturdy and easy-to-fit handrail is ideal for a motorhome or caravan with a lower entry door. In the open position it offers a sturdy grasp handle to help getting in and out the vehicle and in its locked position it folds across the door giving added visible security.

PACK

- 307387 - 1 piece
White
- 308893 - Thule Security Handrail Door Frame Kit
White





Locks

Thule Universal Lock



3 different mounting options with the same lock

This high security lock fits all: motorhome, caravan and van. Possible to mount the same lock in three different ways. The surface-mounted installation is perfect for sliding doors, cabin doors or double rear doors of a van. The wall-mounted and the door frame-mounted installations are perfect for the entrance door, the garage door or the hatches of a motorhome or caravan.

FEATURES

- Large overlap with door for high security
- Strong rotating lock system
- The door frame bracket only requires a 3 mm gap between door and frame
- Fits left or right opening doors
- Available in the colours white and black

PACK

 301406 - 1 piece White	 301408 - 1 piece Black
 301419 - 2 pieces White	 301409 - 2 pieces Black
 301407 - 3 pieces White	

Surface-mounted

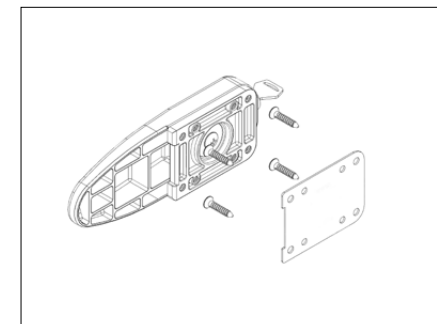

Wall-mounted

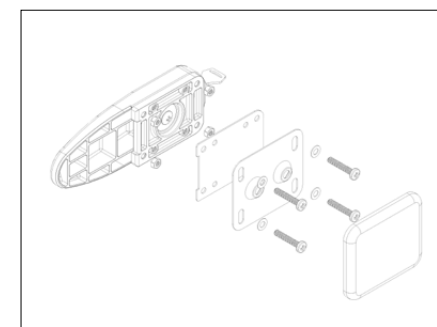

Door frame-mounted

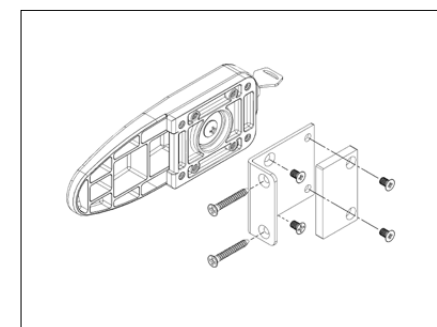

Locks

Thule Inside-Out Lock G2



Secures the entrance door both from the inside and outside

High security lock for motorhome and caravan. This lock is mounted through the wall of your vehicle and secures the entrance door from the inside and outside. It's lockable from both sides but for your safety it can always be opened from the inside without a key.

FEATURES

- Limited space required for installation
- Large overlap with door for high security
- Can be installed horizontally or vertically
- Max. wall thickness: 45 mm

PACK

307339 - 1 piece
White



Locks



Thule Door Lock

This quality door lock is easy to use: just slide it sideways to lock and secure your doors. Mounted through the wall with a mounting plate, a sealing cover and bolts.

PACK

- 308888 - 1 piece
White
- 308890 - 3 pieces
White



Thule Door Frame Lock

This variant of the Thule Door Lock enables installation when there is no space inside the vehicle to fit the mounting plate. Instead of through the wall, it is screwed into the door frame.

PACK

- 308889 - 1 piece
White
- 308891 - 3 pieces
White



Thule Cab Lock

This lock secures your cabin door from the inside with a key. It offers a soft touch cover and matches the colour of your interior. Designed to fit the Fiat Ducato, Citroën Jumper and Peugeot Boxer. Special variant available for MB Sprinter and Renault Master.

PACK

- 309830 - 2 pieces: Ducato
Grey
- 309831 - 2 pieces: Sprinter
Grey



Thule Van Lock

This high security lock helps you to secure rear and sliding side doors. Smart and attractive, it fits all van models and matches the colour of your van's bumper and handles.

PACK

- 309832 - 1 piece
Black
- 309833 - 2 pieces
Black







Visit www.thule.com and discover Thule's wide range of products for an active lifestyle, from bike racks and roof boxes to strollers, luggage and backpacks.



Awnings - Technical Specifications

Wall-mounted Awnings

Thule Omnistor 5200

Manual



Length	Projection	Weight
1.92 m	1.40 m	14.20 kg
2.32 m	1.80 m	17.00 kg
2.62 m	2.00 m	19.00 kg
3.02 m	2.50 m	22.60 kg
3.52 m		25.40 kg
4.02 m		28.00 kg
4.52 m		30.40 kg
5.02 m		32.80 kg

Motorised



Length	Projection	Weight
3.05 m	2.50 m	23.60 kg
3.55 m		26.40 kg
4.05 m		29.00 kg
4.55 m		31.40 kg
5.05 m		33.80 kg

Cassette Finishes

Anodised

White

Anthracite

Thule Omnistor 8000

Manual



Length	Projection	Weight
4.00 m	2.75 m	41.40 kg
4.50 m		44.60 kg
5.00 m		48.20 kg
5.50 m	2.75 m	51.80 kg
6.00 m		55.40 kg

Motorised



Length	Projection	Weight
4.00 m	2.75 m	43.40 kg
4.50 m		46.60 kg
5.00 m		50.20 kg
5.50 m		53.80 kg
6.00 m		57.40 kg

Cassette Finishes

Anodised

White

Cream

Anthracite

Thule Omnistor 4900

Manual



Length	Projection	Weight
2.60 m	2.00 m	17.50 kg
3.00 m	2.50 m	19.60 kg
3.50 m		21.60 kg
4.00 m		25.60 kg
4.50 m		27.80 kg

Cassette Finishes

Anodised

White

Anthracite

Thule Omnistor 5102

Manual



Length	Projection	Weight
2.60 m	2.00 m	19.80 kg

Cassette Finishes

Light grey

Anthracite

Awnings - Technical Specifications

New

Thule 3200

Manual



Length	Projection	Weight
1.90 m	2.50 m	12.00 kg
2.30 m		13.80 kg
2.50 m		14.70 kg
2.70 m		15.60 kg
3.00 m		16.90 kg

NOTE - Available from April 2020

Roof-mounted Awnings

Thule Omnistor 6300

Manual



Length	Projection	Weight
2.60 m	2.00 m	20.60 kg
3.00 m	2.50 m	24.10 kg
3.25 m		25.10 kg
3.50 m		26.80 kg
3.75 m		28.50 kg
4.00 m		30.50 kg
4.25 m		31.80 kg
4.50 m		33.00 kg
5.00 m		35.60 kg

Motorised



Length	Projection	Weight
3.03 m	2.50 m	25.10 kg
3.28 m		26.10 kg
3.53 m		27.80 kg
3.78 m		29.50 kg
4.03 m		31.50 kg
4.28 m		32.80 kg
4.53 m		34.00 kg
5.03 m		36.60 kg

Cassette Finishes



Cassette Finishes



Thule Omnistor 9200

Manual



Length	Projection	Weight
4.00 m	3.00 m	42.40 kg
4.50 m		45.60 kg
5.00 m		50.20 kg
5.50 m		53.60 kg
6.00 m		57.60 kg

Motorised



Length	Projection	Weight
4.00 m	3.00 m	45.40 kg
4.50 m		48.60 kg
5.00 m		53.20 kg
5.50 m		56.60 kg
6.00 m		60.60 kg

Cassette Finishes

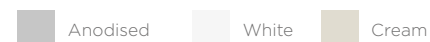

Rail-mounted Awnings

Thule Omnistor 1200

Manual



Length	Projection	Weight
2.30 m	2.00 m	9.00 kg
2.60 m	2.20 m	10.40 kg
3.00 m	2.50 m	12.00 kg
3.25 m		12.60 kg
3.50 m		13.40 kg
3.75 m		14.20 kg
4.00 m		15.00 kg
4.25 m		15.80 kg
4.50 m		16.60 kg
5.00 m		18.40 kg
5.50 m		20.00 kg

Bag Finish



Awnings - Technical Specifications

Wall-mounted Awnings



New

Name	Thule Omnistor 5200		Thule Omnistor 8000		Thule Omnistor 4900	Thule Omnistor 5102	Thule 3200
	Manual	Motorised	Manual	Motorised			
INSTALLATION							
Motorhome	•	•	•	•	•		
Caravan	•	•	•	•	•		
Van	•				•		
Minivan	•				•	• VW T5/T6	•
OPERATION							
Fast gear	•		•		•	•	
By hand							•
Motor	Optional*	12 VDC	Optional	230 VAC			
Integrated tension arms	•	•	•	•			
Quick-Lock system	•	•	•	•		•	•
SPECIFICATIONS							
Min. length	1.92 m	3.05 m	4.00 m	4.00 m	2.60 m	2.60 m	1.90 m
Max. length	5.02 m	5.05 m	6.00 m	6.00 m	4.50 m	2.60 m	3.00 m
Min. projection	1.40 m	2.50 m	2.75 m	2.75 m	2.50 m	2.00 m	2.50 m
Max. projection	2.50 m	2.50 m	2.75 m	2.75 m	2.50 m	2.00 m	2.50 m
Min. weight	14.20 kg	23.60 kg	41.40 kg	43.40 kg	17.50 kg	19.80 kg	12.00 kg
Max. weight	32.80 kg	33.80 kg	55.40 kg	57.40 kg	27.80 kg	19.80 kg	16.90 kg
Cassette finishes	Anodised White Anthracite	Anodised White Anthracite	Anodised White Cream Anthracite	Anodised White Cream Anthracite	Anodised White Anthracite	Light Grey Anthracite	Anthracite Anodised/Anthracite
Fabric finishes	31 - Mystic Grey 32 - Sapphire Blue 04 - Alaska Grey 03 - Blue Sky 22 - Uni Grey	31 - Mystic Grey	31 - Mystic Grey 32 - Sapphire Blue 04 - Alaska Grey 03 - Blue Sky 22 - Uni Grey	31 - Mystic Grey 32 - Sapphire Blue 04 - Alaska Grey 03 - Blue Sky 22 - Uni Grey	31 - Mystic Grey 32 - Sapphire Blue	31 - Mystic Grey	Uni colour grey

NOTE - Lengths are box lengths, the fabric is approximately 20 cm shorter - *Only for awning lengths from 3.00 m and more

Awnings - Technical Specifications

Roof-mounted Awnings



Name	Thule Omnistor 6300		Thule Omnistor 9200	
	Manual	Motorised	Manual	Motorised
INSTALLATION				
Motorhome	•	•	•	•
Caravan	•	•	•	•
Van	•	•		
Minivan				
OPERATION				
Fast gear	•		•	
By hand				
Motor	Optional*	12 VDC	Optional	230 VAC
Integrated tension arms	•	•	•	•
Quick-Lock system	•	•	•	•
SPECIFICATIONS				
Min. length	2.60 m	3.03 m	4.00 m	4.00 m
Max. length	5.00 m	5.03 m	6.00 m	6.00 m
Min. projection	2.00 m	2.50 m	3.00 m	3.00 m
Max. projection	2.50 m	2.50 m	3.00 m	3.00 m
Min. weight	20.60 kg	25.10 kg	42.40 kg	45.40 kg
Max. weight	35.60 kg	36.60 kg	57.60 kg	60.60 kg
Cassette finishes	Anodised White Anthracite	Anodised White Anthracite	Anodised White Cream	Anodised White Cream
Fabric finishes	31 - Mystic Grey 32 - Sapphire Blue	31 - Mystic Grey	31 - Mystic Grey 32 - Sapphire Blue 04 - Alaska Grey 03 - Blue Sky 22 - Uni Grey	31 - Mystic Grey 32 - Sapphire Blue 04 - Alaska Grey 03 - Blue Sky 22 - Uni Grey

NOTE - For fabric availability please contact your Thule recreational vehicle advisor

Rail-mounted Awnings



Name	Thule Omnistor 1200
INSTALLATION	
Motorhome	
Caravan	•
Van	
Minivan	
OPERATION	
Fast gear	
By hand	•
Motor	
Integrated tension arms	
Quick-Lock system	•
SPECIFICATIONS	
Min. length	2.30 m
Max. length	5.50 m
Min. projection	2.00 m
Max. projection	2.50 m
Min. weight	9.00 kg
Max. weight	20.00 kg
Bag finish	White
Fabric finishes	31 - Mystic Grey 32 - Sapphire Blue

Smart Panels - Technical Specifications

Side Panels

Thule Sun Blocker G2



New

Awning type	Projection	A - Mounting height		H - Awning incline	SKU No
TO 5200 • 4900 • 5102 • 6300 • 6200 • 5003	2.00 m	1.90 - 2.24 m	Small	21 cm	307399
T 3200	2.50 m	1.90 - 2.24 m	Small	21 cm	301338
TO 5200 • 4900 • 6300 • 6200 • 5003		2.25 - 2.44 m	Medium	23 cm	307278
		2.45 - 2.64 m	Large	43 cm	307279
TO 1200		2.25 - 2.49 m	TO 1200	48 cm	307398
TO 8000 • 6900	2.75 m	2.25 - 2.44 m	Medium	23 cm	307280
		2.45 - 2.64 m	Large	43 cm	307281
TO 9200	3.00 m	2.25 - 2.44 m	Medium	23 cm	307282
		2.45 - 2.64 m	Large	43 cm	307283

Thule Rain Blocker G2



New

Awning type	Projection	A - Mounting height		H - Awning incline	SKU No
TO 5200 • 4900 • 5102	2.00 m	1.80 - 1.99 m	Minivan*	21 cm	306515
TO 5200 • 4900 • 6300 • 6200 • 5003		2.05 - 2.24 m	Small	23 cm	307400
T 3200	2.50 m	1.80 - 1.99 m	Minivan	21 cm	301339
		2.05 - 2.24 m	Small	23 cm	307291
TO 5200 • 4900 • 6300 • 6200 • 5003		2.25 - 2.44 m	Medium	23 cm	307292
		2.45 - 2.64 m	Large	43 cm	307293
		2.65 - 2.84 m	X-Large	63 cm	307294
TO 1200	2.75 m	2.35 - 2.54 m	TO 1200 V2	50 cm	301422
TO 6300 • 6200		2.35 - 2.54 m	Caravan	33 cm	301332
TO 6300 • 6200		2.30 - 2.50 m	Van**	37 cm	307302
TO 8000 • 6900	2.75 m	2.25 - 2.44 m	Medium	23 cm	307295
		2.45 - 2.64 m	Large	43 cm	307296
		2.65 - 2.84 m	X-Large	63 cm	307297
		2.85 - 3.04 m	XX-Large	83 cm	306516
TO 9200	3.00 m	2.25 - 2.44 m	Medium	23 cm	307298
		2.45 - 2.64 m	Large	43 cm	307299
		2.65 - 2.84 m	X-Large	63 cm	307300
		2.85 - 3.04 m	XX-Large	83 cm	306517



*Minivan

- VW California T5/T6 > 2003
- PSA Minivan > 2016



**Van

- Fiat Ducato > 2006
- Peugeot Boxer > 2006
- Citroën Jumper > 2006
- VW Crafter > 2017

NOTE - Thule Rain Blocker G1 Side Panels are available for Thule Omnistor Caravan, Caravan Style and 2000

Thule View Blocker G2



Awning type	Projection	A - Mounting height		H - Awning incline	SKU No
TO 5200 • 4900 • 6300 • 6200 • 5003	2.50 m	2.25 - 2.44 m	Medium	23 cm	308380
		2.45 - 2.64 m	Large	43 cm	308381

A = Distance between bottom of awning cassette and ground

Smart Panels - Technical Specifications

Front Panels

Thule Sun Blocker G2



Awning type	Length	Fits min. awning length	Height	SKU No
All Thule Omnistor awnings	1.00 m	-	1.70 m	307284
	2.40 m	2.60 m		307285
	2.80 m	3.00 m		307286
	3.30 m	3.50 m		307287
	3.80 m	4.00 m		307288
	4.30 m	4.50 m		307289
	4.80 m	5.00 m		307290

NOTE - Can be used in combination with the Thule Residence G3 tent with the optional connections profiles - 301567

Thule Rain Blocker G2



	Awning type	Panel type	Length	Height	SKU No
	Combine with Side Panel: Minivan				
New	T 3200	J	1.12 m	1.85 m	301354
	T 3200 • TO 5200 • 4900 • 5102	A	1.27 m		306454
New	T 3200	K	1.47 m		301355
New	T 3200	L	1.81 m		301356
	Combine with Side Panels: Small and TO 1200 V2				
	All Thule Omnistor awnings	B	1.27 m	2.10 m	301320
		C	1.47 m		301321
		D	1.67 m		301322
		E	1.92 m		301323
	Combine with Side Panels: Medium, Large, X-Large, XX-Large, Van and Caravan				
	All Thule Omnistor awnings	F	1.02 m	2.30 m	307303
		G	1.52 m		307304
		H	1.72 m		307305
		I	2.00 m		307306

Thule Rain Blocker G2 Pack Minivan



Awning type	Packaging	SKU No
TO 4900 • 5102	2x Thule Rain Blocker G2 Side Minivan 2x Thule Rain Blocker G2 Front A (1.27 m) Storage bag	301329

Thule View Blocker



Awning type	Length	Fits min. awning length	Height	SKU No
All Thule Omnistor awnings	2.40 m	2.60 m	1.40 m	307588
	2.80 m	3.00 m		307592
	3.30 m	3.50 m		307594
	3.80 m	4.00 m		307596
	4.30 m	4.50 m		307598
	4.80 m	5.00 m		307600

NOTE - Can be used in combination with the Thule Residence G3 tent with the optional connections profiles - 301567

Smart Panels - Technical Specifications

Thule Rain Blocker G2 Front Combinations

Panel type

The Thule Rain Blocker G2 front panels exist in 3 different heights and in several lengths.

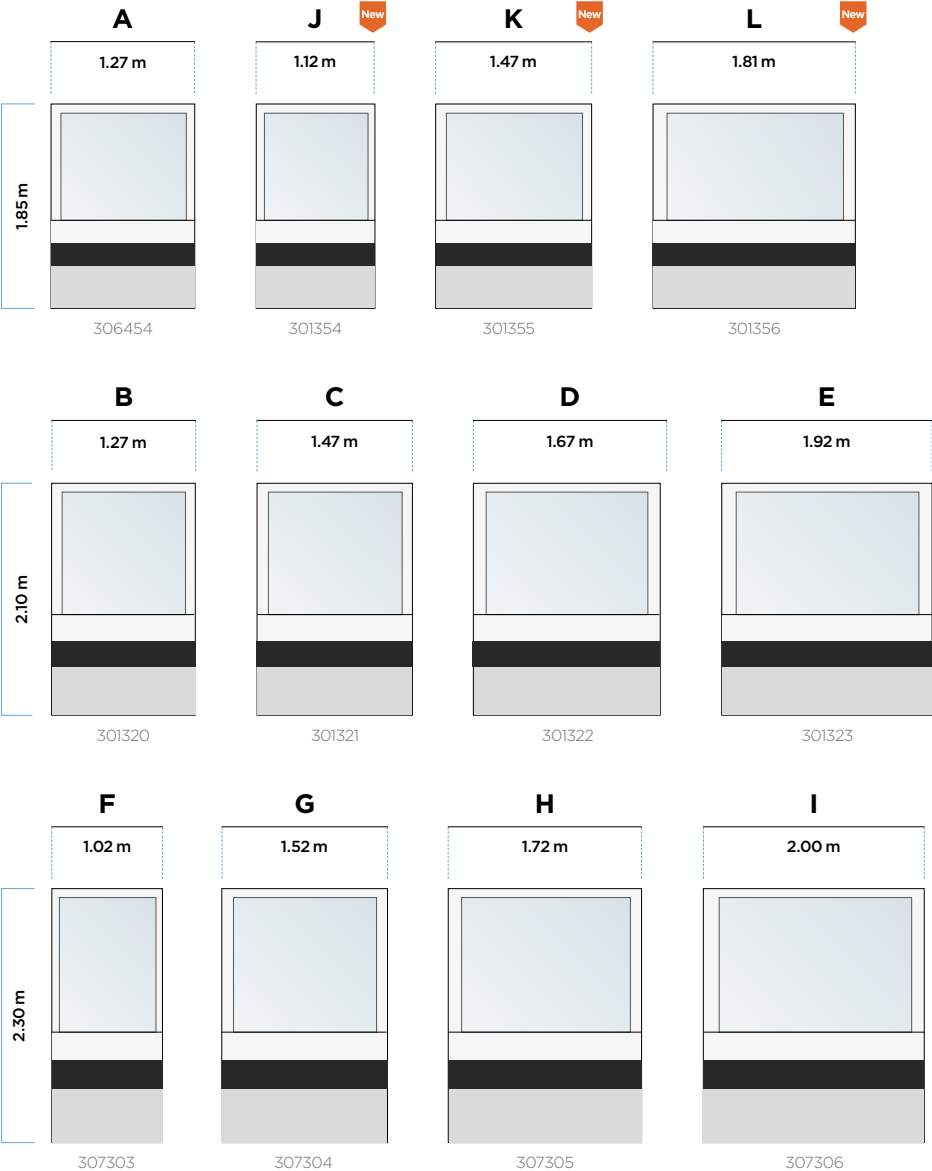

Front combination

When desired, a full front combination can be made, compatible with your side panel and depending on your awning length.

Compatible side panel	Awning length (± L)		Front combination
MINIVAN	2.50 m	T 3200	J + A (set: 301360)
	2.60 m	TO 4900 - TO 5102	A + A (set: 301361)
	2.70 m	T 3200	J + K (set: 301362)
	3.00 m	T 3200 - TO 4900	J + L (set: 301363)
S TO 1200 V2	2.60 m		B + B
	2.80 m		B + C
	3.00 m		B + D
	3.25 m		B + E
	3.50 m		C + E
	3.75 m		D + E
	4.00 m		E + E
	4.25 m		B + C + C
	4.50 m		C + C + C
	5.00 m		D + D + D
M L XL XXL VAN CARAVAN	5.50 m		D + E + E
	3.00 m		F + F + F
	3.25 m		G + H
	3.50 m		F + G + F
	3.75 m		H + I
	4.00 m		F + I + F
	4.25 m		F + G + H
	4.50 m		F + I + G
	5.00 m		G + I + G
	5.50 m		I + G + I
	6.00 m		I + I + I

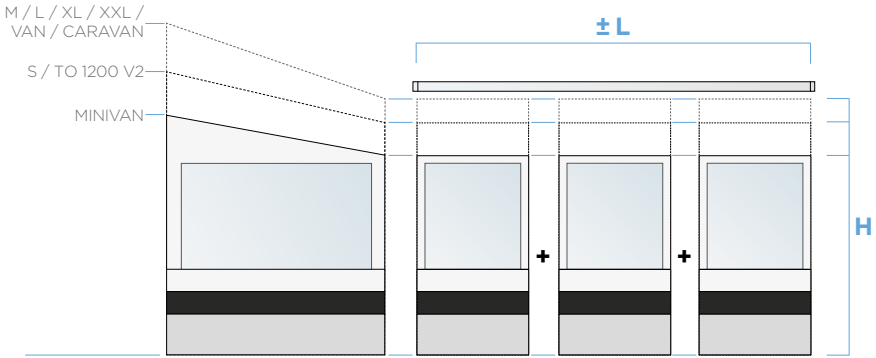

Smart Panels - Technical Specifications



Thule Windscreen	
Name	
SKU No	306456
Fabric's height	1.38 m
Total height	1.55 m
Length	3.00 m
Weight	4.5 kg

Boxes for roof mounting - Technical Specifications



Name	Thule Force XT		
	S	M	L
SKU No	635100	635200	635700
INSTALLATION			
Motorhome	•	•	•
Caravan	•	•	•
Van	•	•	•
SPECIFICATIONS			
Volume	300 L	400 L	450 L
Product dimensions (L x W x H)	139 x 89.5 x 39 cm	175 x 82 x 45.5 cm	190 x 84 x 46 cm
Internal dimensions (L x W x H)	127 x 78 x 34 cm	162 x 71 x 40 cm	177 x 73 x 41 cm
Load capacity	75 kg	75 kg	75 kg
Product weight	14.3 kg	16.4 kg	18.7 kg
Material	Black Aeroskin		
Mounting system	PowerClick		
Locking system	CentralLock		
Box opening	DualSide		

NOTE - When mounted on load bars Thule ProBar Flex, use Thule T-Track Adapter 697600

Tents - Technical Specifications



Name	Thule Veduta				Thule Panorama			Thule Residence G3		
Stay	Long stay				Long stay			Long stay		
INSTALLATION										
Motorhome					•			•		
Caravan	•				•			•		
Van					• Ducato H2					
Minivan										
FITS										
Awnings	Thule Omnistor 6300 • 6200				Thule Omnistor 5200 • 8000 • 5003 • 5002 • 5500 • 6300 • 9200 • 6200 • 6002			Thule Omnistor 5200 • 8000 • 4900 • 5003 • 5002 • 5500 • 6300 • 9200 • 6200 • 6900 • 6002		
Awning lengths	4.00 - 5.00 m				3.00 - 6.00 m			3.00 - 6.00 m		
Mounting heights	2.45 - 2.59 m				2.30 - 2.74 m			2.15 - 3.10 m		
Vehicle wall	Straight wall				Straight wall			Straight wall		
SPECIFICATIONS										
Maximum tent length	5.00 m				6.00 m			6.00 m		
Fabric	AIRTEX® fabric				AIRTEX® fabric			PVC fabric		
Colour	Black, grey and white				Black, grey and white			Black, grey and white		
Curtains	Optional				Optional			Optional		
Windslip	Included				Included			Included (with front panel)		
Wheelcover	Included				Optional (included for Ducato H2)			Optional		
Storage bag	2 Luxury bags				2 Luxury bags			2 Luxury bags (included with side panels)		
	Models	A - Mounting height	H	SKU No	Models	A - Mounting height	H	Models	A - Mounting height	H
	4.00 m Large	2.45 - 2.59 m	-60 cm	301350	Medium	2.30 - 2.44 m	-45 cm	Small	2.15 - 2.29 m	-30 cm
	4.25 m Large			301351	Large	2.45 - 2.59 m	-60 cm	Medium	2.30 - 2.44 m	-45 cm
	4.50 m Large			301352	X-Large	2.60 - 2.74 m	-75 cm	Large	2.45 - 2.59 m	-60 cm
	5.00 m Large			301353	Ducato H2	2.30 - 2.50 m	-45 cm	X-Large	2.60 - 2.74 m	-75 cm
Weight for a 3.00 m Medium tent: 29.5 kg								XX-Large	2.75 - 2.89 m	-75 cm
								XXX-Large	2.90 - 3.10 m	-90 cm

Weight for a 3.00 m Medium tent: 29.5 kg
Weight for a 6.00 m Large tent: 35.5 kg

Weight for a 3.00 m Medium tent: 27 kg
Weight for a 6.00 m X-Large tent: 33.5 kg

NOTE - Front and side panels need to be ordered separately

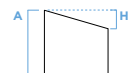

A = Distance between bottom of awning cassette and ground
H = Awning incline

Tents - Technical Specifications



New



Name	Thule Residence G3 for Eriba Touring		Thule Residence G3 for Volkswagen T5/T6		Thule QuickFit					
Stay	Short stay		Short stay		Short stay					
INSTALLATION										
Motorhome					•					
Caravan	• Eriba Touring				•					
Van					• Ducato H2					
Minivan			• VW T5/T6							
FITS										
Awnings	Thule Omnistor 6300		Thule Omnistor 5102 • Original Volkswagen awning		Thule Omnistor 5200 • 8000* • 4900 • 5003 • 5002 • 5500 • 6300 • 9200* • 6200 • 6900* • 6002 • 1200 + other brands					
Awning lengths	3.25 m		2.60 m		3.00 - 6.00 m					
Mounting heights					2.25 - 2.84 m					
Vehicle wall					Straight wall					
SPECIFICATIONS										
Maximum tent length	3.25 m		2.60 m		3.60 m					
Fabric	PVC fabric		PVC fabric		RIPSTOP fabric					
Colour	Black, grey and white		Black, grey and white		Black, grey and white					
Curtains	Optional		Optional		Included					
Windslip	Included		Included		Included					
Wheelcover	Included		Included		Included					
Storage bag	Included		Included		Sport bag					
Weight: 25 kg	Model		SKU No		Models		A - Mounting height		H	SKU No
	Eriba Touring	301593	VW T5/T6	301560	2.60 m	Medium	2.25 - 2.44 m	-35 cm	307056	
					3.10 m	Medium			309921	
					3.60 m	Medium			307058	
					2.60 m	Large	2.45 - 2.64 m	-45 cm	307057	
					3.10 m	Large			309922	
					3.60 m	Large			307059	
					2.60 m	X-Large	2.65 - 2.84 m	-65 cm	309920	
					3.10 m	X-Large			309923	
					3.60 m	X-Large			309924	
					3.00 m	Ducato H2	2.30 - 2.50 m	-45 cm	307060	

Weight: 25 kg

Weight: 21 kg

Weight for a 2.60 m Medium tent: 15.7 kg
Weight for a 3.60 m X-Large tent: 18.4 kg

*With accessory 307052
Thule Projection Kit

Rear Wall-mounted Bike Racks - Technical Specifications



Name	Thule Lift V16		Thule Excellent		Thule Elite G2	
	Manual	Motor 12V	Standard	Short	Standard	Short
SKU No	307368	307369	309821 - Anodised 302033 - Black	309822	306560	306561
INSTALLATION						
Motorhome	•	•	•	•	•	•
Caravan	•	•	•	•	•	•
Van						
SPECIFICATIONS						
Finish	Anodised	Anodised	Anodised or Black	Anodised	Anodised	Anodised
Standard number of bikes	2	2	2	2	2	2
Max. number of bikes (optional)	3 (+ 307370)	3 (+ 307370)	4 (+ 309823 + 309824 : ano) (+ 302034 + 302035 : black)	4 (+ 309823 + 309824)	4 (+ 306565 + 309824)	4 (+ 306565 + 309824)
Loading weight	50 kg	50 kg	60 kg	60 kg	60 kg	60 kg
Max. bike weight	30 kg	30 kg	30 kg	30 kg	30 kg	30 kg
Max. bike weight 4 th rail	-	-	15 kg	15 kg	15 kg	15 kg
Fits E-bikes	•	•	•	•	•	•
For vertical walls between	70 - 95 cm (+ 307371 : up to 150 cm)	70 - 95 cm (+ 307371 : up to 150 cm)	80 - 150 cm	60 - 80 cm	80 - 150 cm	50 - 80 cm
Product dimensions (L x W x H)	131 x 70 x 95 cm	131 x 70 x 95 cm	131 x 73 x 150 cm	131 x 73 x 80 cm	131 x 74 x 150 cm	131 x 74 x 80 cm
Product weight	17 kg	18.1 kg	10.6 kg	10.6 kg	10.1 kg	9.5 kg
Sliding rails left-right			•	•	•	•
Sliding rails in depth			•	•		
Lockable platform	Manual	Manual	Automatic	Automatic	Manual	Manual
Lockable bike holders	•	•	•	•	•	•
Rail distance (2 bikes)	30 cm	30 cm	20 cm	20 cm	30 cm	30 cm
Rail distance (max. number of bikes)	15 cm	15 cm	15 cm	15 cm	15 cm	15 cm
Wheel mounting	Adjustable wheel holders with pump buckles	Adjustable wheel holders with pump buckles	Adjustable wheel holders with pump buckles	Adjustable wheel holders with pump buckles	Adjustable wheel holders with buckles	Adjustable wheel holders with buckles
One-Key System compatible	•	•	•	•	•	•

Rear Wall-mounted Bike Racks - Technical Specifications



New



Thule Elite G2 One Bike
302047
•
•
Anodised
1
1
30 kg
30 kg
-
•
80 - 150 cm
131 x 41 x 150 cm
6.7 kg
•
Manual
•
-
-
Adjustable wheel holders with buckles
•

Name	Thule Sport G2		Thule Sport G2	Thule Sport G2	Thule Sport G2	Thule Sport G2
	Standard	Short	Tour	Hobby	Universal	
SKU No	307126	307127	306572	307128	306563	
INSTALLATION						
Motorhome	•	•	•			
Caravan	•	•	•	•	•	
Van						
SPECIFICATIONS						
Finish	Anodised	Anodised	Anodised	Anodised	Anodised	Anodised
Standard number of bikes	2	2	2	2	2	2
Max. number of bikes (optional)	3 (+ 306577)	3 (+ 306577)	3 (+ 306577)	3 (+ 306577)	3 (+ 306577)	2
Loading weight	50 kg	50 kg	50 kg	50 kg	50 kg	38 kg
Max. bike weight	19 kg	19 kg	19 kg	19 kg	19 kg	19 kg
Max. bike weight 4 th rail	-	-	-	-	-	-
Fits E-bikes	Yes, with accessory 306945	Yes, with accessory 306945	Yes, with accessory 306945	Yes, with accessory 306945	Yes, with accessory 306945	Yes, with accessory 306945
For vertical walls between	80 - 150 cm	40 - 70 cm	80 - 150 cm	79 cm	135 - 70 cm	
Product dimensions (L x W x H)	126 x 65 x 150 cm	126 x 68 x 70 cm	126 x 70 x 150 cm	126 x 65 x 79 cm	126 x 65 x 175 cm	
Product weight	8.2 kg	7.9 kg	6.8 kg	6.8 kg	8 kg	
Sliding rails left-right	•	•	•	•	•	
Sliding rails in depth						
Lockable platform	Manual	Manual	Manual	Manual	Manual	Manual
Lockable bike holders	Optional key locks	Optional key locks	Optional key locks	Optional key locks	Optional key locks	Optional key locks
Rail distance (2 bikes)	30 cm	30 cm	30 cm	30 cm	30 cm	15 cm
Rail distance (max. number of bikes)	15 cm	15 cm	15 cm	15 cm	15 cm	-
Wheel mounting	Straps	Straps	Straps	Straps	Straps	Straps
One-Key System compatible	•	•	•	•	•	•

A-frame-mounted Bike Racks - Technical Specifications



Name	Thule Caravan Superb		Thule Caravan Superb XT Black		Thule Caravan Smart	Thule Caravan Light
	Standard	Short	Standard	Short		
SKU No	307130	307329	302031	302030	307129	306598
INSTALLATION						
Motorhome						
Caravan	•	•	•	•	•	•
Van						
SPECIFICATIONS						
Finish	Anodised	Anodised	Black	Black	Anodised	Anodised
Standard number of bikes	2	2	2	2	2	2
Max. number of bikes (optional)	3 (+ 307131)	2	3 (+ 302032)	2	2	2
Loading weight	60 kg	60 kg	60 kg	60 kg	50 kg	40 kg
Max. bike weight	30 kg	30 kg	30 kg	30 kg	30 kg	20 kg
Fits E-bikes	•	•	•	•	•	
Product dimensions (L x W x H)	130 x 57 x 85 cm	130 x 49 x 85 cm	130 x 57 x 85 cm	130 x 49 x 85 cm	130 x 44 x 85 cm	126 x 20 x 68 cm
Product weight	9.7 kg	9.6 kg	10 kg	9.9 kg	8.9 kg	4.7 kg
Sliding rails left-right						
Sliding rails in depth						
Lockable platform	Manual	Manual	Manual	Manual	Manual	
Lockable bike holders	•	•	•	•	•	
Rail distance (2 bikes)	28 cm	20 cm	28 cm	20 cm	15 cm	20 cm
Rail distance (max. number of bikes)	14 cm	-	14 cm	-	-	-
Wheel mounting	Straps	Straps	Adjustable wheel holders with pump buckles	Adjustable wheel holders with pump buckles	Straps	Straps
Tiltable with bikes on	•	•	•	•	•	Partly tiltable (without bikes)
Adjustable Tilt-Stop System	•	•	•	•	•	
Fits short A-frames		•		•	•	
One-Key System compatible	•	•	•	•	•	

Garage-mounted Bike Racks - Technical Specifications



Name	Thule VeloSlide		Thule Sport G2 Garage
	Standard	Short	
SKU No	302014 + mounting rails	302044 + mounting rails	306574
INSTALLATION			
Motorhome	•	•	•
Caravan			
Van			
SPECIFICATIONS			
Finish	Anodised	Anodised	Anodised
Standard number of bikes	2	2	2
Max. number of bikes (optional)	2	2	4 (+ 306577 + 306578)
Loading weight	70 kg	70 kg	50 kg
Max. bike weight	35 kg	35 kg	19 kg
Max. bike weight 4 th rail	-	-	19 kg
Fits E-bikes	•	•	
Product dimensions (L x W x H)	195 x 125 x 80 cm	180 x 125 x 80 cm	126 x 66 x 79 cm
Product weight	20.9 kg	19.9 kg	5.6 kg
Sliding rails left-right			•
Sliding rails in depth			
Lockable platform	Automatic	Automatic	
Lockable bike holders	Optional key locks	Optional key locks	Optional key locks
Rail distance (2 bikes)	25 cm	25 cm	30 cm
Rail distance (max. number of bikes)	-	-	15 cm
Wheel mounting	Pump buckles	Pump buckles	Straps

302015 - Mounting Rails: 70 cm
302016 - Mounting Rails: 140 cm

Rear Door-mounted Bike Racks - Technical Specifications



New



New



Name	Thule WanderWay	Thule Elite Van XT				Thule Sport G2 Compact
SKU No	911001	307340	302013	302018	302043	307341
INSTALLATION						
Motorhome						
Caravan						
Van		• Fiat Ducato • Peugeot Boxer • Citroën Jumper ≥ 2007		• VW Crafter ≥ 2017	• Mercedes Sprinter > 2006 • VW Crafter 05/2006-2017	•
Minivan	• VW T6					
SPECIFICATIONS						
Finish	Anodised/Black	Anodised	Black	Black	Black	Anodised
Standard number of bikes	2	2	2	2	2	2
Max. number of bikes (optional)	4 (+ 911600 + 911700)	2	2	2	2	2
Loading weight	60 kg	35 kg	35 kg	35 kg	35 kg	35 kg
Max. bike weight	30 kg (2-bike) – 20 kg (3-bike)	19 kg	19 kg	19 kg	19 kg	19 kg
Max. bike weight 4 th rail	15 kg	-	-	-	-	-
Fits E-bikes	•					
Product dimensions (L x W x H)	91 x 152 x 111 cm	130 x 55 x 125 cm	130 x 55 x 125 cm	130 x 55 x 125 cm	130 x 55 x 125 cm	126 x 55 x 150 cm
Product weight	13.9 kg	10.5 kg	10.5 kg	10.5 kg	10.5 kg	7.2 kg
Sliding rails left-right	•					
Sliding rails in depth						
Lockable platform	Automatic	Manual	Manual	Manual	Manual	Manual
Lockable bike holders	•	•	•	•	•	Optional key locks
Rail distance (2 bikes)	31 cm	20 cm	20 cm	20 cm	20 cm	20 cm
Rail distance (max. number of bikes)	15 cm	-	-	-	-	-
Wheel mounting	Adjustable wheel holders with pump buckles	Adjustable wheel holders with buckles	Adjustable wheel holders with buckles	Adjustable wheel holders with buckles	Adjustable wheel holders with buckles	Straps
One-Key System compatible	•	•	•	•	•	•



Roof Rack System - Technical Specifications

Name	Thule SmartClamp System		
SKU No	301640	301641	301642
INSTALLATION			
Motorhome			
Caravan			
Van	• Fiat Ducato • Peugeot Boxer • Citroën Jumper ≥ 06/2006		
SPECIFICATIONS			
Vehicle size	L2H2 (length: 5.4 m)	L3H2 (length: 6 m)	L4H2 (length: 6.4 m)
Max. load roof rack	150 kg	200 kg	200 kg
Fits awning length	3.25 m	3.75 m	4.00 m
Weight	9 kg	11 kg	12 kg
CONTENT			
Base rails	2 x 2.83 m	2 x 3.44 m	2 x 3.78 m
Smart clamps	6	8	8



NameThule ProBar Flex		
	High (set of 2)	Low (set of 2)
SKU No	301647	301648
INSTALLATION		
Motorhome		
Caravan		
Van	•	•
SPECIFICATIONS		
Height (load bar to roof)	13 cm	10 cm
Length	1.50 m	1.50 m
Max. load (per set)	75 kg	75 kg
Weight (per set)	8.3 kg	7.9 kg



NameThule Van Ladder 9 Steps	
SKU No	301404
INSTALLATION	
Motorhome	
Caravan	
Van	•
SPECIFICATIONS	
Steps	9
Max. load	150 kg
Dimensions closed (L x W x H)	49 x 7 x 75 cm
Dimensions open (L x W x H)	49 x 7 x 264 cm
Weight ladder	8.1 kg
Storage bag	•



NameThule Ladder Fixation Kit	
SKU No	301405
INSTALLATION	
Motorhome	
Caravan	
Van	•
SPECIFICATIONS	
Max. load organizers	10 kg
Dimensions (L x W x H)	66 x 10 x 8 cm
Weight	1.2 kg
Storage bag	•

NOTE: includes Thule Ladder Fixation Kit

Locks - Technical Specifications



Name	Thule Security Handrail		Thule Universal Lock					Thule Inside-Out Lock G2
	Standard	Short						
SKU No	308892	307387	301406	301419	301407	301408	301409	307339
INSTALLATION								
Motorhome	•	•	•	•	•	•	•	•
Caravan	•	•	•	•	•	•	•	•
Van			•	•	•	•	•	
SPECIFICATIONS								
Fits left and right opening doors	•	•	•	•	•	•	•	
Material	Solid powder-coated aluminium		Solid powder-coated aluminium					Solid powder-coated aluminium
Colour	White		White			Black		White
Pack	1 pc	1 pc	1 pc	2 pcs	3 pcs	1 pc	2 pcs	1 pc
Weight/pc (netto)	2.000 kg	1.850 kg	0.540 kg 0.760 kg 0.720 kg (depending on mounting installation)					0.940 kg



Name	Thule Door Lock		Thule Door Frame Lock		Thule Cab Lock		Thule Van Lock	
SKU No	308888	308890	308889	308891	309830	309831	309832	309833
INSTALLATION								
Motorhome	•	•	•	•	• Fiat Ducato > 2007 • Citroën Jumper > 2007 • Peugeot Boxer > 2007	• Mercedes Sprinter > 2006 • VW Crafter > 2006 • Renault Master > 2010 • Opel Movano > 2010		
Caravan	•	•	•	•				
Van							•	•
SPECIFICATIONS								
Fits left and right opening doors	•	•	•	•				
Material	Solid powder-coated aluminium		Solid powder-coated aluminium		Solid lacquered aluminium		Solid powder-coated aluminium	
Colour	White		White		Grey		Black	
Pack	1 pc	3 pcs	1 pc	3 pcs	2 pcs		1 pc	2 pcs
Weight/pc (netto)	0.850 kg		0.840 kg		1.085 kg	1.355 kg	0.525 kg	

› Bring your board
Bring your bike
Bring your skis
Bring your gear
Bring your kids
Bring your love
Bring your passion
Bring your dreams
Bring your life





Thule nv

Kortrijkstraat 343 - BE - 8930 Menen
+32 56 52 88 99 - InfoRV@thule.com
www.thule.com

302542 - EN - Local variations in product range may occur and products may be subject to change without further notice. With reservation against possible mistakes in the contents of the catalogue. Concept + graphic design: Herve Ménard. Photography: Brian Declercq, South Side Agency, David Meignan, Eleonora Raggi, Tobias Ilseker, Fabienne Nury. Print: De Maertelaere bvba.

